

22 Swan Street, Werribee

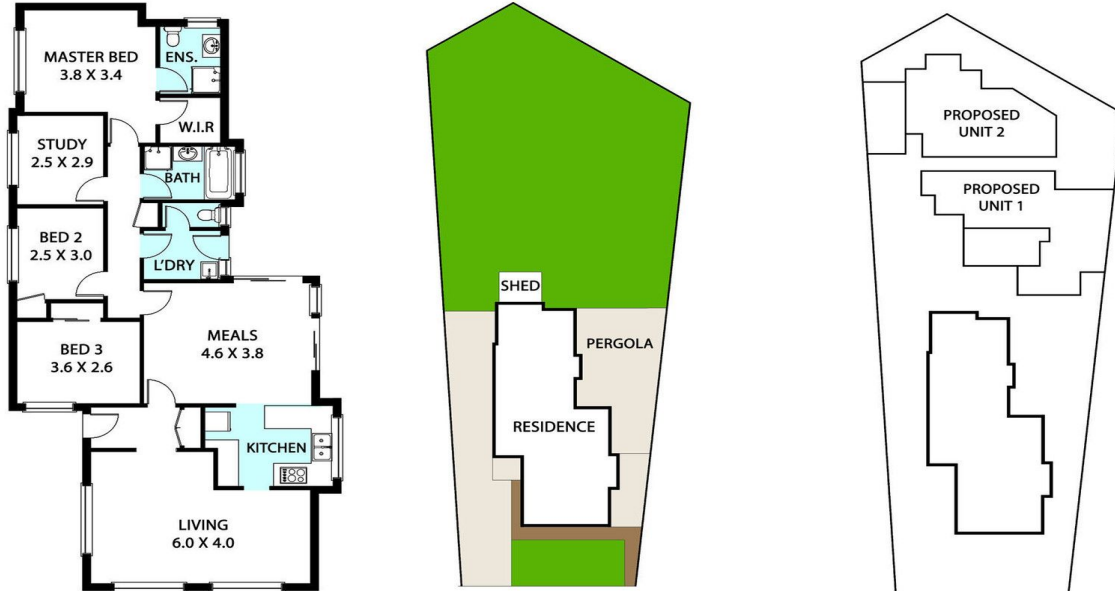

PLEASE NOTE: ALL STATED DIMENSIONS ARE APPROXIMATE ONLY. PROSPECTIVE BUYERS ARE ADVISED TO MAKE THEIR OWN INQUIRIES.



22 Swan Street WERRIBEE VIC

4 2 2

Lifetime opportunity for someone who is looking to buy a first home, or seeking an investment or looking for development project in a very central location of Werribee close to Pacific Werribee, Sims Shopping Centre, medical centres, schools and all the amenities you could have.

We are proudly presenting an established home with plans and permits approved for 2 units at the back. The existing home is returning \$1521 rent per month with secured tenants happy to stay.

Consisting of:

Three large bedrooms.

Fourth bedroom/study.

Master bedroom with ensuite and walk-in robes.

Huge formal living upon entrance.

Practical kitchen leads to good size meals/family area leads out to massive backyard.

Good size kitchen gas cooktop, pantry and lot of cupboard

Building Size : 22 sqm

Land Size : 895 sqm

View : <https://www.ypa.com.au/7360828>