



9 Macalister Court WERRIBEE VIC

3 1 2

Set on an impressive allotment of 569m² (approx.) this lovely home is the perfect start for a first home owner or a savvy investor looking to add to their portfolio. With this property set close to reputable schools including Westgrove Primary School, Bethany Primary School, Wyndham Central, local shops and parks you'll struggle to find a better location, Pacific Werribee is also only a 7-minute drive away and werribee CBD & Railway station only 9 mins away! The home offers;

Building Size : 13 sqm
Land Size : 569 sqm
View : <https://www.ypa.com.au/7361039>

- Three spacious & fitted bedrooms
- Large central bathroom
- Formal lounge
- Kitchen/meals area
- Stainless steel appliances including dishwasher
- Large pergola and additional timber decked gazebo
- Ducted heating
- Evaporative cooling



Mitch Smit
0450 913 513

9 Macalister Court, Werribee

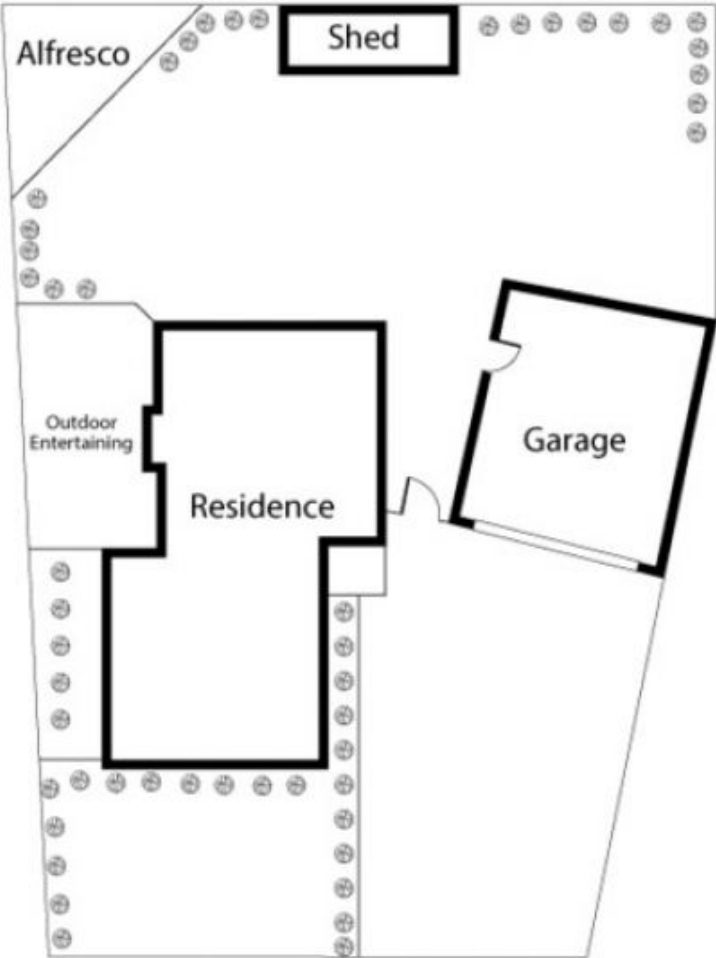

Every care has been taken to verify the correctness of details in this property plan. The plan is a representation only and is not necessarily to scale.