



12/13-19 Tariff Court Werribee VIC

2 🚗

Located in a prominent industrial pocket with great exposure and minutes to Werribee CBD! This near new warehouse is versatile & can be suitable for so many different businesses.

Offering:

- ? Container high electric roller door
- ? Security bollards at roller door
- ? 3 phase power
- ? Bathroom with toilet, vanity & shower
- ? Kitchenette (Hot water)
- ? Private parking right in front of the factory & plenty of customer parking

(PHOTO ID REQUIRED AT OPEN FOR INSPECTION)

'At YPA Estate Agents, our service will move you'

Building Size : 155 sqm
View : <https://www.ypa.com.au/7364353>



James Antonio
0401 889 248

12/13-18 TARRIF COURT, WERRIBEE

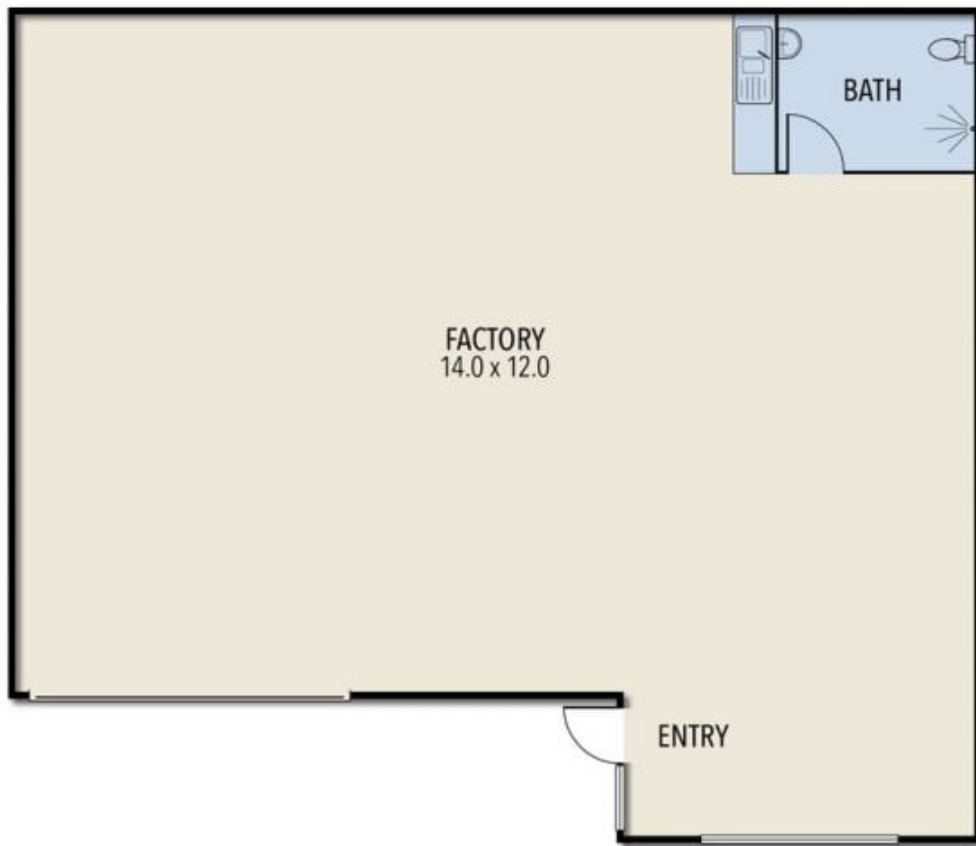

ALL STATED DIMENSIONS ARE APPROXIMATE ONLY. PARTICULARS GIVEN ARE FOR GENERAL INFORMATION ONLY
AND DO NOT CONSTITUTE ANY REPRESENTATION ON THE PART OF THE VENDOR AND AGENT.