



## 5 St Andrews Way DARLEY VIC

3  1  1 

Bathed in picturesque, uninterrupted views of the Lerderberg State Park, outdoor privacy and serenity like this is hard a rare find. This magnificent family home positioned on an enormous 1154m<sup>2</sup> (approx.) sought after block, performs a perfect job at containing the true essence of what it means to live in this exclusive pocket of one of Victorias most historic towns, Impressing at first sight, blending sleek renovations with modern comfort, it proudly defines this desirable and captivating family home.

Comprising of three great sized bedrooms with built in mirrored sliding robes, large master bedroom equipped with full walk in robe and ensuite. With sweeping views from almost every room, the inviting and flexible floor plan with large front living area ensures room for all the family.

The central hub of the home has been built with style and

**Land Size** : 1154 sqm

**View** : <https://www.ypa.com.au/7382890>



**Shane O'Brien**  
0431 766 082

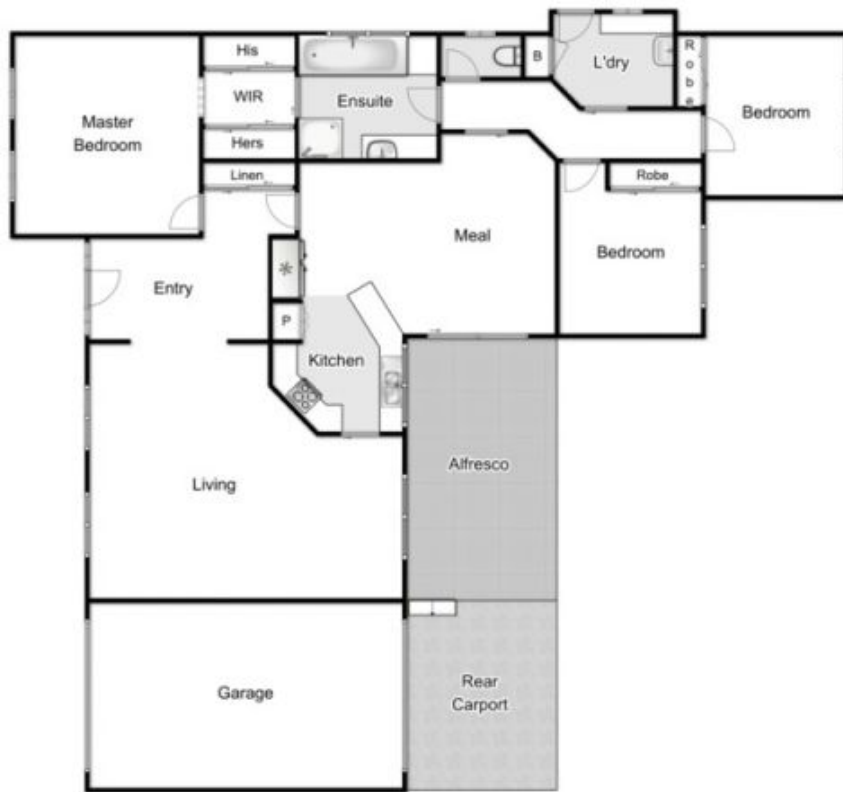

## 5 Saint Andrews Way, Darley



every attempt has been made to ensure the accuracy of the floor plan contained here, measurements of doors, windows, rooms and any other items are approximate and no responsibility is taken for any error, omission, or mis-statement. an is for illustrative purposes only and should be used as such by any prospective purchaser. The services, systems and appliances shown have not been tested and no guarantee as to their operability or efficiency can be given.

