



6B Manor Street BACCHUS MARSH VIC

3  2  2 

Introducing a new take on contemporary living, this luxurious modern residence boasts expansive outdoor spaces circling finely crafted interiors, employing a suite of high-end elements of which words cannot do justice.

Located in Bacchus Marsh's most highly sought after historical precinct, this property combines a sleek and modern haven with a historically rich postcode. Surrounded by a multitude of parkland, bike and walking tracks, excellent transport options and the vivacious community of Bacchus Marsh on its doorstep add to the unique character this home has on offer.

As you enter the home, you are greeted with an oversized front door which seamlessly blends with your deluxe hardwood flooring that is continued up your beautifully designed staircase to your second story, luxury comes in all shapes and sizes, another huge feature for this home is your option to use your very own, private personal elevator

Land Size : 516 sqm

View : <https://www.ypa.com.au/7382895>



Shane O'Brien
0431 766 082



First Floor



Ground Floor

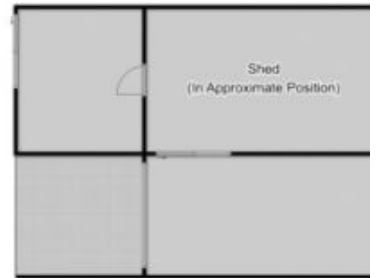

6B Manor Street, Bacchus Marsh



every attempt has been made to ensure the accuracy of the floor plan contained here, measurements of doors, windows, rooms and any other items are approximate and no responsibility is taken for any error, omission, or mis-statement. an is for illustrative purposes only and should be used as such by any prospective purchaser. The services, systems and appliances shown have not been tested and no guarantee as to their operability or efficiency can be given.

