



20 Connor Street BACCHUS MARSH VIC

3 2 3

This 3 bedroom home is move in ready, with master having ensuite and WIR, with remaining bedrooms both having BIRs. With 2nd bathroom servicing back two bedrooms with shower, bath and separate toilet. The central kitchen is a good size with almost new SS appliances including oven, rangehood and dishwasher with microwave space also. There is a dining and living area also with a split system and ceiling fans for year-round comfort. Outside features a huge undercover entertaining area and carport with drive through access to the 6mt X 9mt shed. Shed is concreted with power, lighting, fireplace separate alarm system, will fit easily two cars as well as a workshop space.

There is an extensive grassed backyard area for your kids or four-legged friends. This property is a short drive to Main Street, Train station and Freeway access.

It will not last call today to inspect!!

(Photo ID is Required at all Open For Inspections)

Land Size : 659 sqm

View : <https://www.ypa.com.au/7383031>



Jodi Nash
0419 342 120

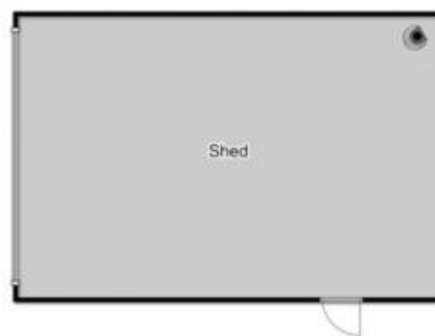

20 Connor Street, Bacchus Marsh

every attempt has been made to ensure the accuracy of the floor plan contained here, measurements of doors, windows, rooms and any other items are approximate and no responsibility is taken for any error, omission, or mis-statement. an is for illustrative purposes only and should be used as such by any prospective purchaser. The services, systems and appliances shown have not been tested and no guarantee as to their operability or efficiency can be given.

