



## 10 Lawrence Avenue SUNBURY VIC

3 2 1

Living in Lawrence Avenue in the well-regarded Killara Estate will set up your familys future or perhaps youre an astute investor looking to secure a property in a well-established family pocket. Either way, this is certainly a home to put to the top of your Must See list.

**View :** <https://www.ypa.com.au/7388261>

### Comprising:

- 3 bedrooms, all with BIRs, master with WIR and FES
- Galley style kitchen with upright gas oven, d/washer and plenty of bench and cupboard space
- Multiple living zones
- Dining area
- Study space or formal dining area
- Laundry with ext access
- Family bathroom
- Ducted heating, Coonara-style wood heater and evap

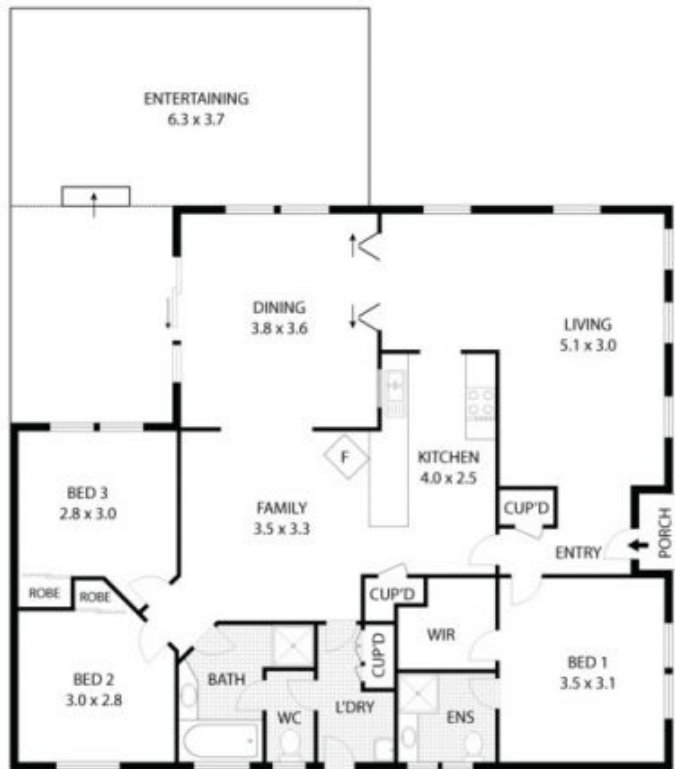
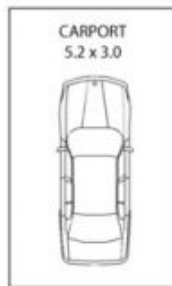

Scale in metres. Indicative only. Dimensions are approximate. All information contained herein is gathered from sources we believe to be reliable. However we cannot guarantee its accuracy and interested parties should rely on their own enquiries.

RESIDENCE - 112m<sup>2</sup>  
CARPORT - 15m<sup>2</sup>  
ENTERTAINING - 36m<sup>2</sup>



# 10 Lawrence Avenue, Sunbury