



6 Manolive Court SUNBURY VIC

4 2 1

Located in a tranquil court within the Kismet Park Estate, this charming family home could be your future. Offering 4 bedrooms, all with BIRs, master with WIR & FES, two living areas, dining area, spacious kitchen including dishwasher as well as a family bathroom and laundry with external access. Additional features include: separate toilet, gas log fire, wall furnace and wood heating, evap cooling, large garage with drive through access, lockable garden shed and roller shutters. Situated amidst a natural parkland environment, walking tracks and short walk to the beautiful Spavin Lake, as well as local schools and the #489 bus nearby, this home is certainly the perfect, well rounded family home for you. Make sure this one is at the very top of your short list! Call today to arrange your private inspection. **Photo ID required at Open for Inspections.

View : <https://www.ypa.com.au/7388268>

Sealed bid ends at 6.00pm on 4 October, 2016 (if not sold

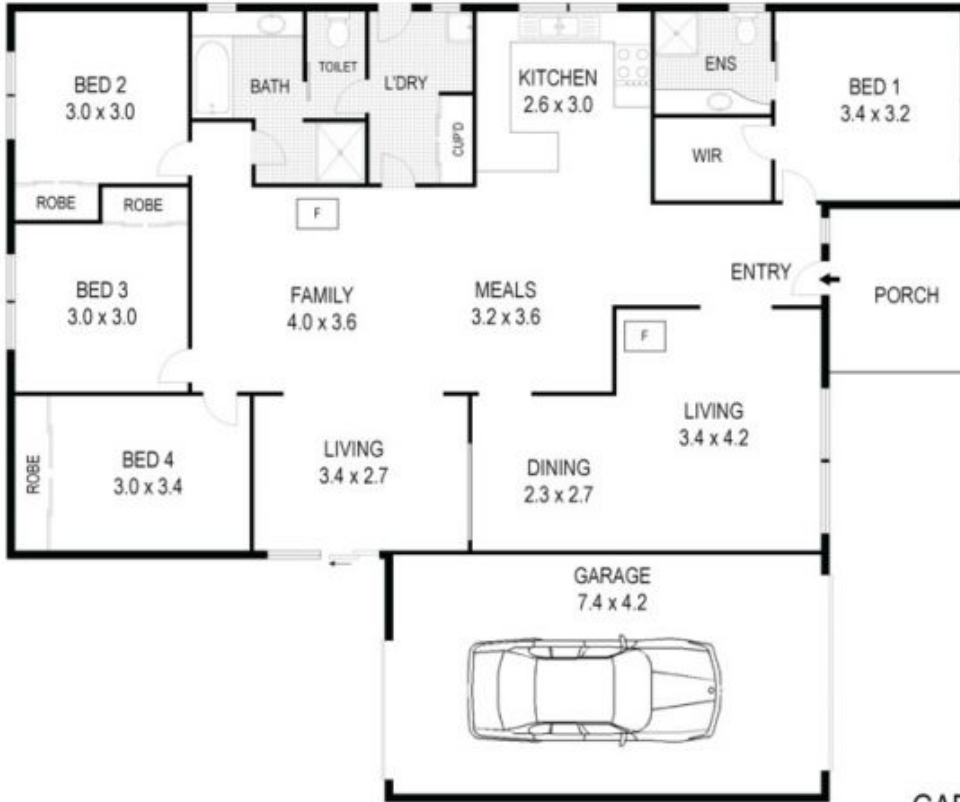

Scale in metres. Indicative only. Dimensions are approximate. All information contained herein is gathered from sources we believe to be reliable. However we cannot guarantee its accuracy and interested parties should rely on their own enquiries.

GARAGE - 31m²
 PORCH - 6m²
 RESIDENCE - 183m²



6 Manolive Court, Sunbury