



9 Heatherbrae Crescent SUNBURY VIC

4 2 3

Make yourself at home in the peaceful and beautiful Strathearn Glen Estate. Set on an impressive block size of 922m² approx & beaming with natural sun light comes a spacious and well thought out floorplan which delivers a wonderfully relaxing ambience that you just cannot ignore. Close to local schools, public transport, only minutes from the heart of town this exceptional home covers all the bases for the modern & growing family.

Property features include:

4 Bedrooms with BIRs Master complete with FES

Central bathroom with separate toilet

Spacious kitchen with plenty of bench and cupboard space complete with s/steel appliances Dishwasher, gas cooktop & electric oven

Separate living areas

Laundry with outside access

Year round comfort is assured with a split system, ceiling

View : <https://www.ypa.com.au/7388278>



Lisa Totaro
0410 144 215

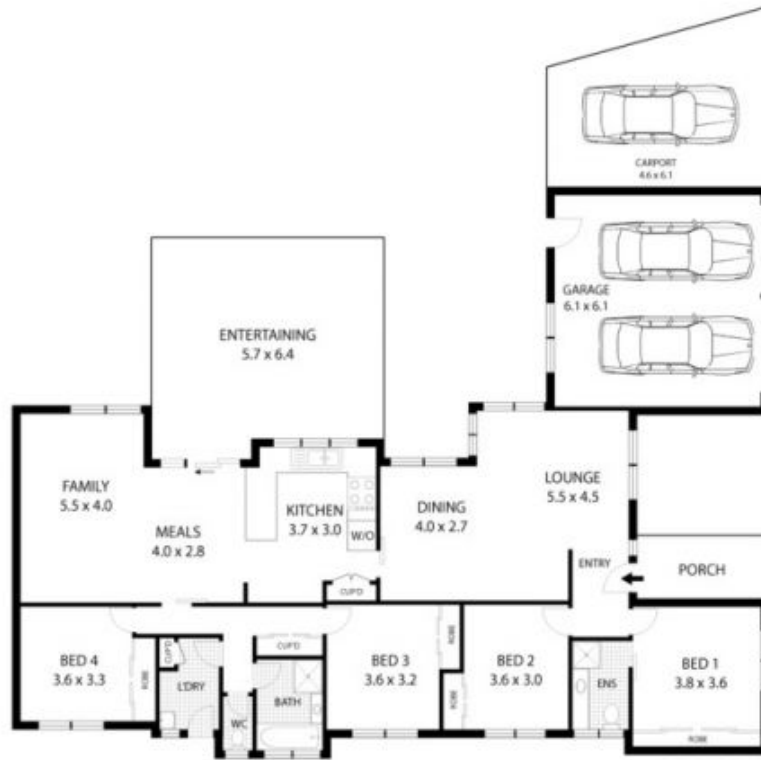

RESIDENCE	- 167m ²
ENTERTAINING	- 38m ²
PORCH	- 7m ²
GARAGE	- 36m ²
CARPORT	- 25m ²



0 1 2 3 4 5

Scale in metres. Indicative only. Dimensions are approximate. All information contained herein is gathered from sources we believe to be reliable. However we cannot guarantee its accuracy and interested parties should rely on their own enquiries.

9 Heatherbrae Crescent, Sunbury