



252 Elizabeth Drive SUNBURY VIC

4  2  1 

With absolutely nothing to do, this standout property is ready and waiting for you to move right in and enjoy! The light filled home has a spacious floor plan, manicured gardens & a superior location; being walking distance to primary and secondary schools, town centre, and picturesque parklands with public transport on your door step. Set on a block size of 662m² approx. welcome to a home where years of family enjoyment is guaranteed.

Property features include:

- 4 Bedrooms with BIR Master complete with FES
- Spacious kitchen with adjoining dining & living area -
- Kitchen with quality s/steel appliances, gas cooktop, electric oven & dishwasher
- Formal step down lounge
- Central bathroom with separate toilet
- Generous laundry with outside access

View : <https://www.ypa.com.au/7388285>



Lisa Totaro
0410 144 215

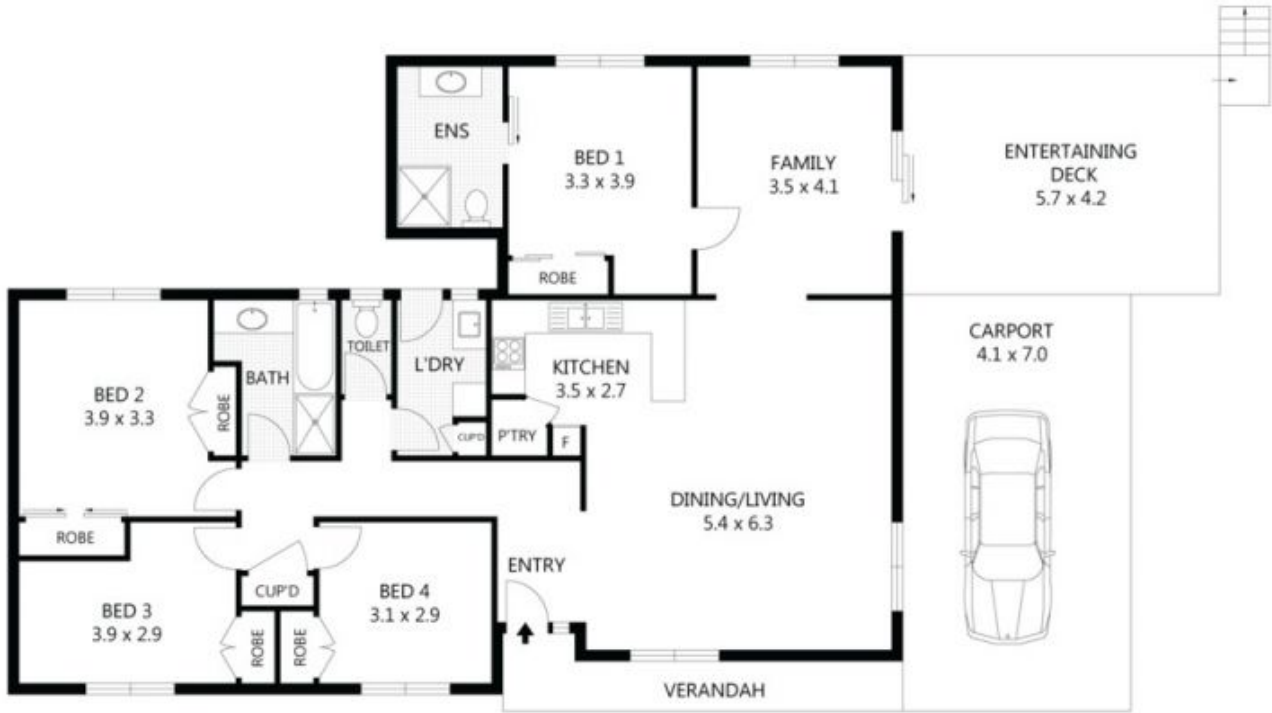

Scale in metres. Indicative only. Dimensions are approximate. All information contained herein is gathered from sources we believe to be reliable. However we cannot guarantee its accuracy and interested parties should rely on their own enquiries.

| | | |
|-------------------|---|-------------------------|
| ENTERTAINING DECK | - | 24m ² |
| CARPORT | - | 31m ² |
| VERANDAH | - | 7m ² |
| RESIDENCE | - | 137m² |



252 Elizabeth Drive, Sunbury