



## 52 Rutherglen Way TAYLORS LAKES VIC

4  2  2 

Contemporary, grand and sublime elegance merge with seamless perfection in this inspired family residence. Focusing on seamless indoor/outdoor living, the home has been designed, detailed and constructed with a meticulous eye, to capture and maximise a wealth of natural light without compromising on privacy.

In addition, this home features an amazing kitchen with a movable island bench that effortlessly interacts with the living, meals and outdoor area. A significant presentation with striking native gardens, this tranquil retreat enjoys a convenient location walking distance to the schools, parklands, shops and bus routes.

Lavishly appointed in every detail overlooking Taylors Lakes creek, this ex display home enjoys many resort facilities complete with a undercover alfresco area,

**View** : <https://www.ypa.com.au/7391088>



Ground Flr

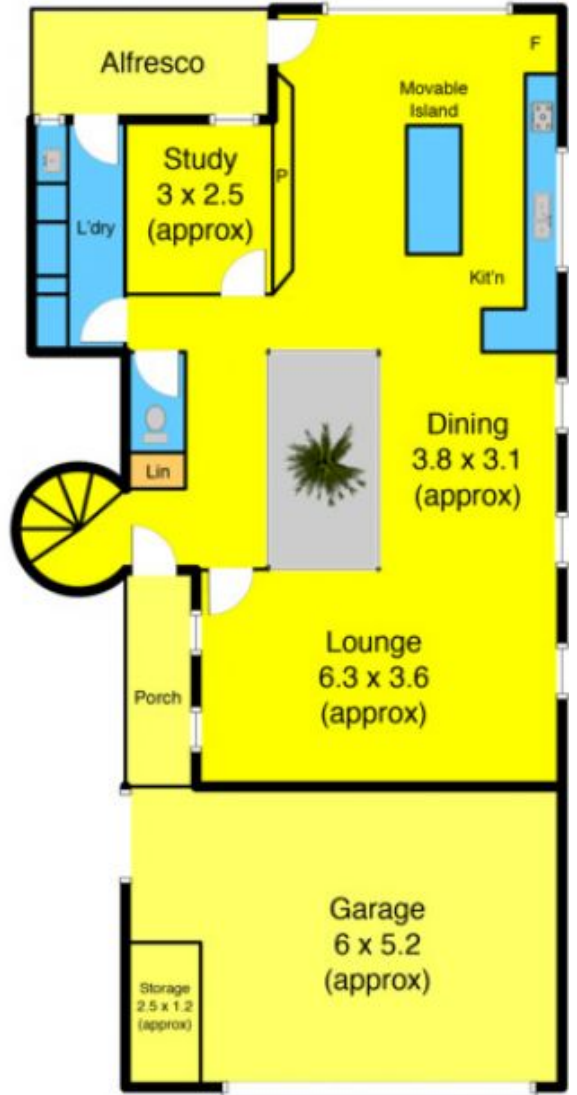

1st Flr

