



40 Flinders Avenue ROSEBUD VIC

3 **2** **4**

****CLICK ON THE VIDEO BUTTON TO WATCH A FULL VIDEO TOUR (Not just a photo slideshow!) OF THIS PROPERTY!****

Land Size : 1007 sqm
View : <https://www.ypa.com.au/7392612>

Peacefully situated down a quiet winding no-through road, this one-owner, craftsman-built home incorporates all the space you need- inside and out. On a quarter of an acre* and boasting one of the largest garages/ workshops we have ever seen, this residence will delight those seeking a renovated family home. Light-filled and ready to enjoy, stroll to the local shops or within minutes you can be by the bay, golf courses and nature trails.

Featuring:

Three very large bedrooms plus the all-important study
Massive walk-in robe and ensuite to the master bedroom

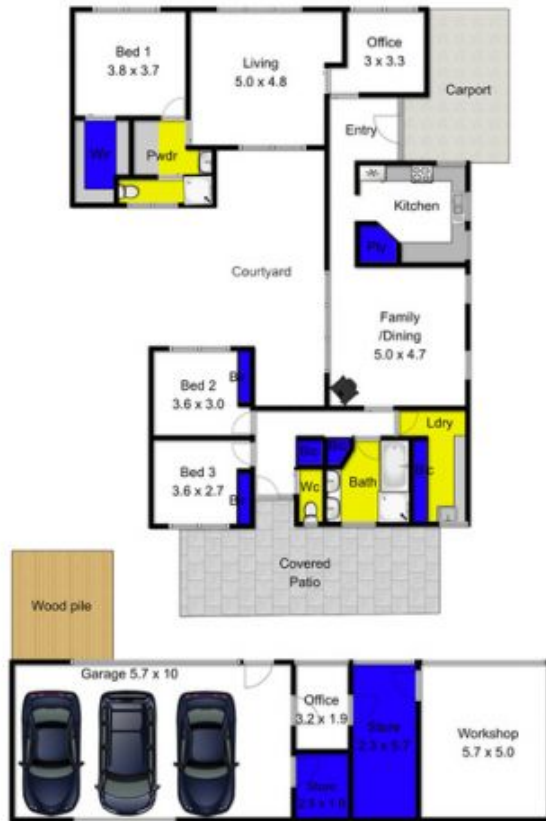

40 Flinders Avenue, Rosebud

Fixtures & Fittings are for display purposes only, not to scale.

Produced by Open2view.com