



PANORAMIC BAY VIEWS



201 Marine Drive MOUNT MARTHA VIC

5 3 2

Boasting panoramic blue water vistas as they stretch around Port Phillip Bay, this is your chance to secure 'the best seats in the house.' Offering flexible living options for home or holidays, you will forever love coming home to these tantalising views.

Land Size : 1417 sqm

View : <https://www.ypa.com.au/7392698>

Featuring:

- Private allotment of 1417 sqm* accessed via Oban Road
- Three level coastal-inspired property, purpose built into hillside Mt Martha to maximise the show stopping views
- Five bedrooms serviced by a bathroom on each level
- Options aplenty with the lower level offering fully self-contained accommodation (including a large kitchenette and bathroom)
- Walls of glass seamlessly link the informal living area to the outdoors providing the ultimate backdrop for waterside

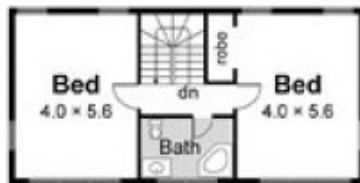

Upper floor



Middle floor



Ground Floor

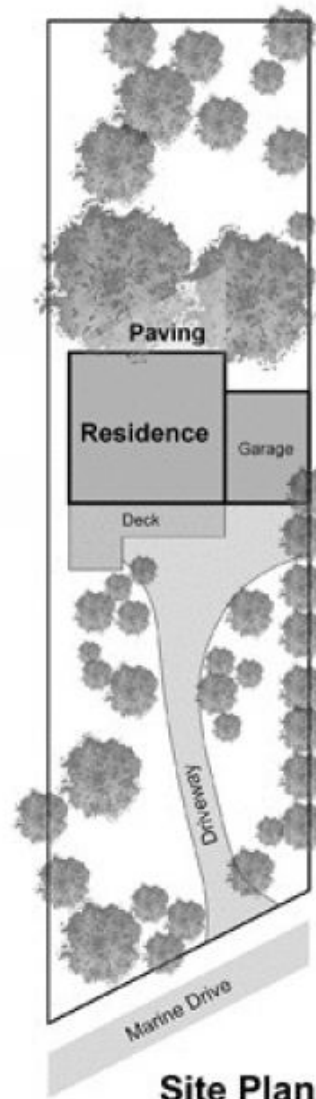

Site Plan

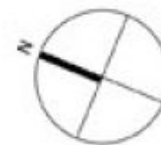

201 Marine Drive, Mount Martha

This floorplan is for illustration purposes only and no warranty is given to its accuracy. Purchasers are advised to carry out their own investigations. Produced by **realitywriters** (03) 5974 1586