



## 125 Rainier Avenue DROMANA VIC

3 1 2

This solid brick-veneer home represents value in an increasingly sought-after neighbourhood. With generous proportions and light and airy interiors, the level allotment and huge storage shed is yet another bonus in this value-packed package.

### Featuring:

- Three bedrooms, including a walk-in robe and two-way en suite to the master bedroom

- Raked ceilings and easy-care flooring enhance the sense of space

- Nestled on a fantastic parcel of land with level lawn areas- ideal for entertaining and the children/ pets

- Central bathroom with both shower and bath, as well as a separate laundry and toilet

- Huge shed at the rear of the property- perfect for the

**Land Size** : 710 sqm

**View** : <https://www.ypa.com.au/7392831>



**Ben Nutbean**  
0413 125 996

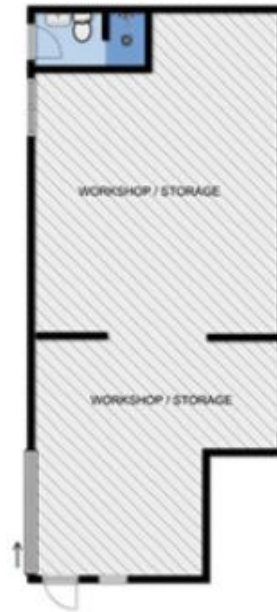

WORKSHOP



RESIDENCE

# 125 RAINIER AVE DROMANA

This image is an artistic representation. It is the responsibility of all interested parties to verify all data depicted and omitted.