



7 Dorothea Crescent DROMANA VIC

4 2 2

Offering the chance to secure your very own beach house with a captivating view, this much-loved property is being presented to the market for the very first time. Spreading over two levels and offering an abundance of living and sleeping accommodation, come and seize the potential of these blissful bay vistas.

Featuring:

- Solidly-built with bedrooms and bathrooms on both levels
- Four bedrooms in total, all boasting large built-in robes
- Far-reaching blue water views from the upper level which are afforded both inside and outside
- Seamless access to the alfresco area from the upstairs living zone
- Plentiful storage including under stair area, a separate cellar and double garage
- Large rear garden with masses of potential for additional outdoor entertaining that is also ideal for pets and children

Price : \$ 637,000

Land Size : 532 sqm

View : <https://www.ypa.com.au/7392832>



MAIN LEVEL

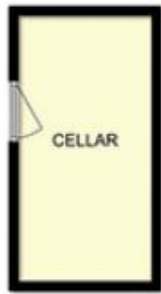

LOWER LEVEL

7 DOROTHEA CRES DROMANA

This image is an artistic representation. It is the responsibility of all interested parties to verify all data depicted and omitted.