



23 Greenhill Road ROSEBUD VIC

4 2 2

Peacefully set near the end of quiet cul-de-sac, this contemporary home exemplifies the best of family living.

Land Size : 790 sqm
View : <https://www.ypa.com.au/7393090>

Featuring:

Towering two-storey design built to take full advantage of the treetop and water views

Fronted by a balcony that runs the width of the home; allowing you to take in Arthurs Seat and the bay, plus the passing ships towards Portsea and the Bellarine Peninsula

Only a few years young with a modern, monochromatic colour palette

Huge rear garden a haven for those who love entertaining or with children and pets (plus potential for boat storage or



UPPER LEVEL

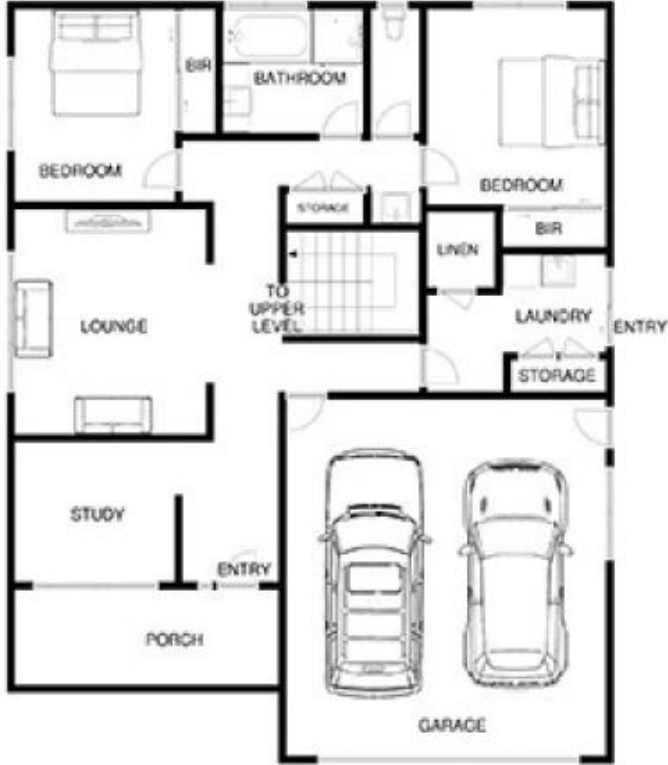

MAIN LEVEL



SITE

23 GREENHILL RD ROSEBUD

This image is an artistic representation. It is the responsibility of all interested parties to verify all data depicted and omitted.