



## 14 Loongana Street RYE VIC

3 2 4

Light-filled and welcoming, this beach house suits buyers who live locally, as well as those seeking a relaxed weekender or a pad with potential.

**Land Size** : 608 sqm  
**View** : <https://www.ypa.com.au/7393106>

### Featuring:

Nestled in a quiet pocket where the local streets are lined by the Moonah trees; evoking a distinctive coastal charm

The elevated interiors enjoy treed outlooks and boast raked ceilings and neutral tones

Extensive workshop/ storage area underneath the home with adjoining access to the double carport

Sitting on a sought-after corner allotment of 608sqm\* with the option to add further value by closing in the lower level



MAIN LEVEL

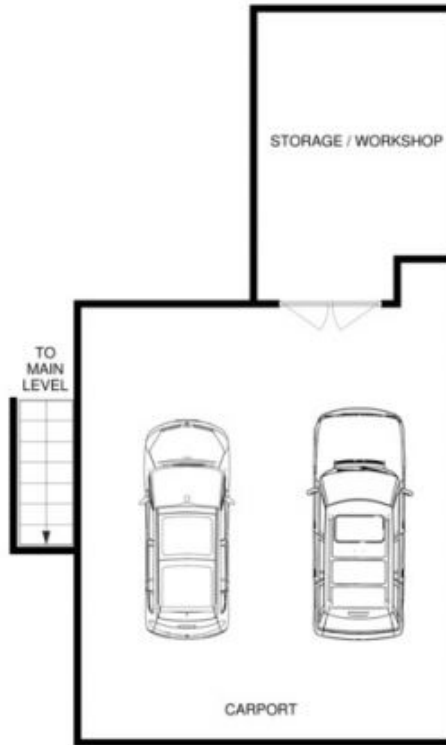

LOWER LEVEL

0M 5M

# 14 LOONGANA ST RYE

This image is an artistic representation. It is the responsibility of all interested parties to verify all data depicted and omitted.



SITE