



1/314 Eastbourne Road ROSEBUD VIC

3 1 2

UNIT 1 - \$490,000
UNIT 2 - UNDER CONTRACT

View : <https://www.ypa.com.au/7393139>

All of your investment, first home buyer or downsizer dreams will have come true at once after you inspect this fantastic property so centrally located, convenience really is 'on your doorstep'!

Only 1.1km approx to Rosebud Plaza and the sandy foreshore, a quick 1.3km approx to the entrance to the freeway and surrounded by great local amenities such as the Rosebud RSL, Country Club, Golf Course and Hospital as well as being within minutes of the Rosebud Cinemas and an array of fantastic bars and restaurants.

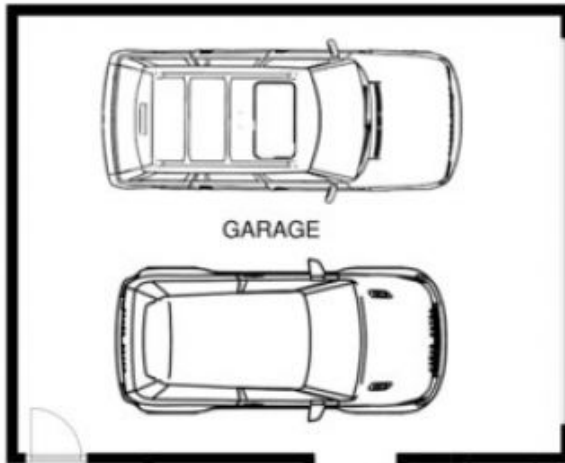

SITE

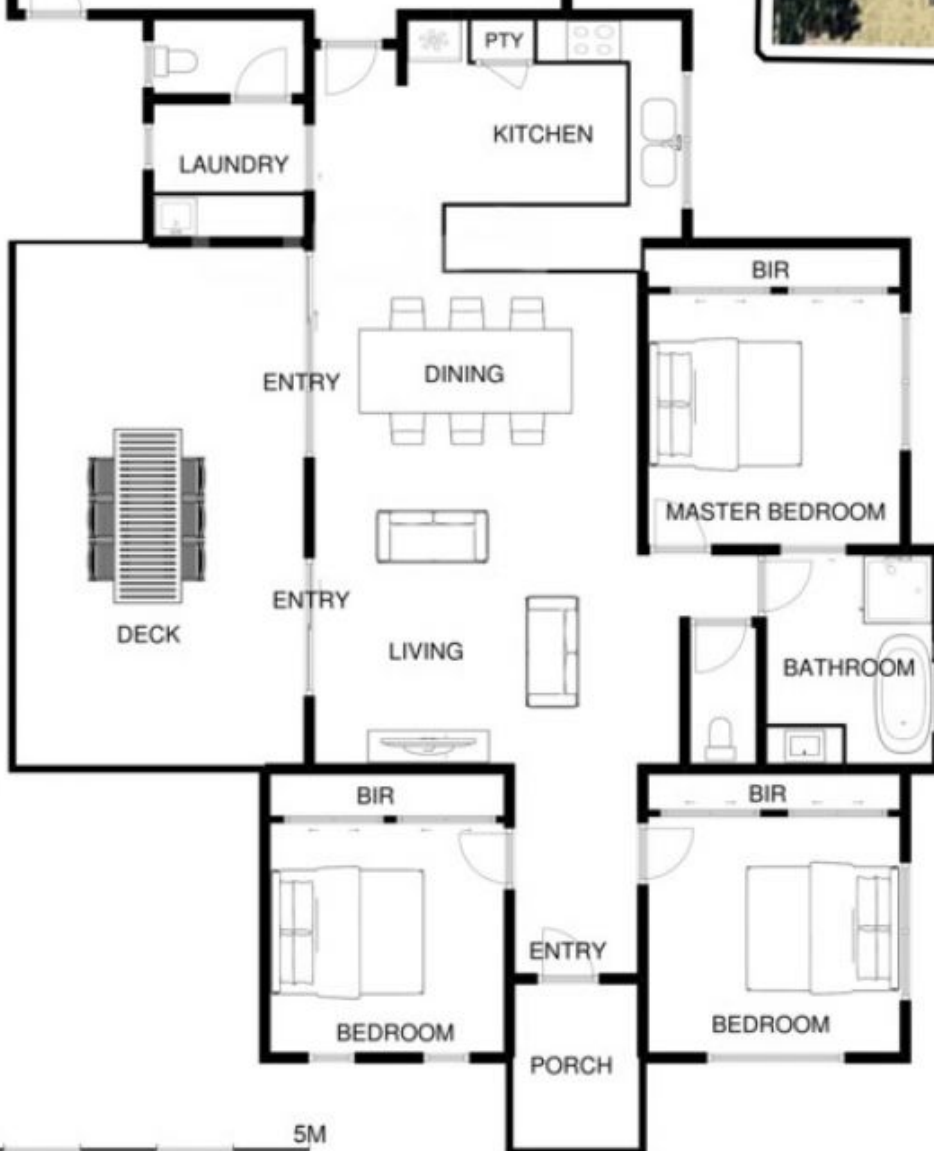

RESIDENCE

1/314 EASTBOURNE RD ROSEBUD

This image is an artistic representation. It is the responsibility of all interested parties to verify all data depicted and omitted.

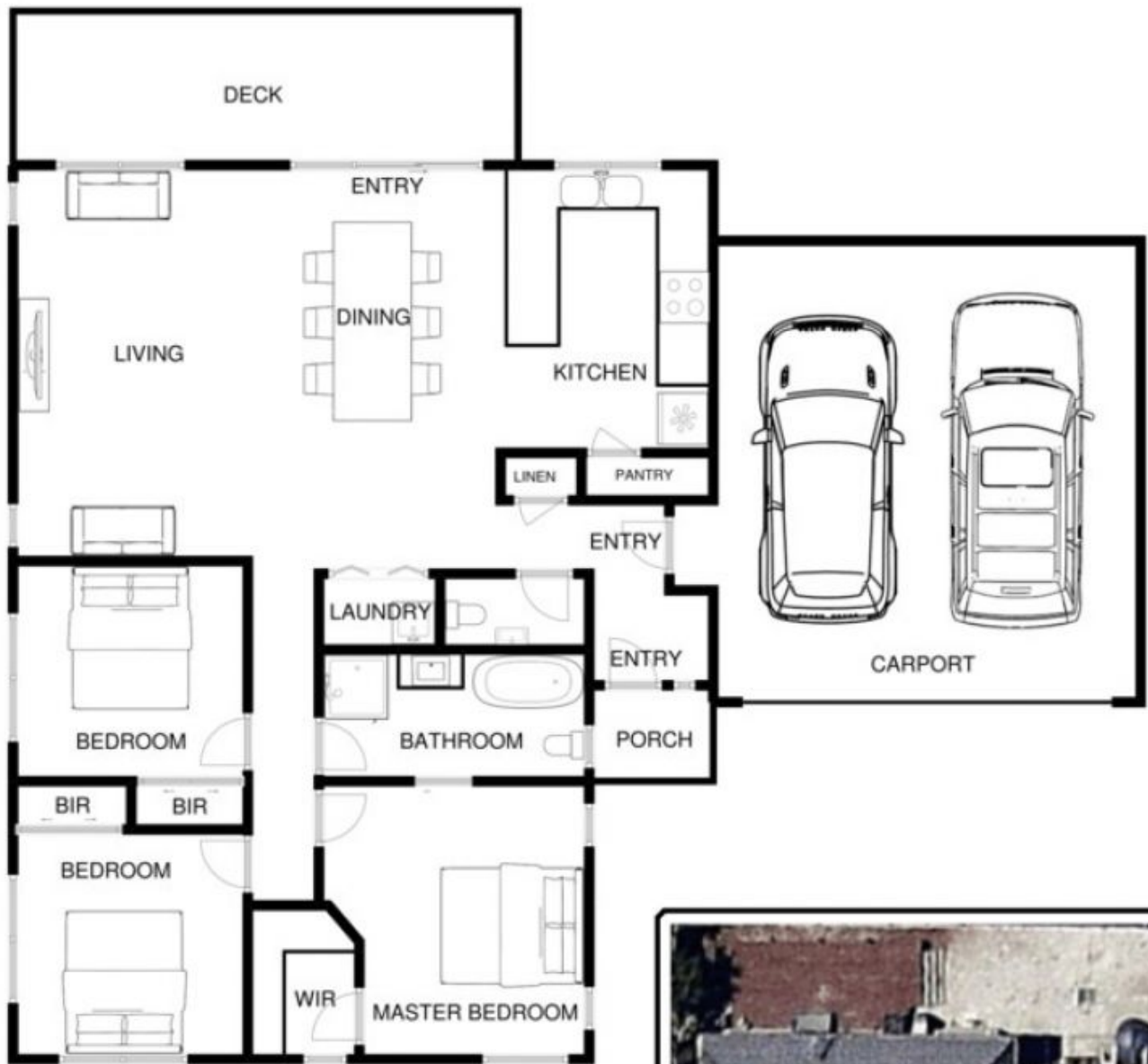

RESIDENCE

0M 5M



SITE

2/314 EASTBOURNE RD ROSEBUD

This image is an artistic representation. It is the responsibility of all interested parties to verify all data depicted and omitted.