



## 28 Capel Avenue CAPEL SOUND VIC

3  2 

An absolute stunning transformation has undergone this gorgeous weatherboard cottage with all the amenities you would expect in a brand new build.

**Land Size** : 677 sqm

**View** : <https://www.ypa.com.au/7393146>

Stunning colour palate with textured finishes complemented by coastal low maintenance gardens.

3 spacious bedrooms with high ceilings, plantation shutters and split systems

Bathrooms with marble effect tiling and walk in showers

Engineered timber flooring throughout

Spacious modern kitchen including under mount sink and easy use wall oven

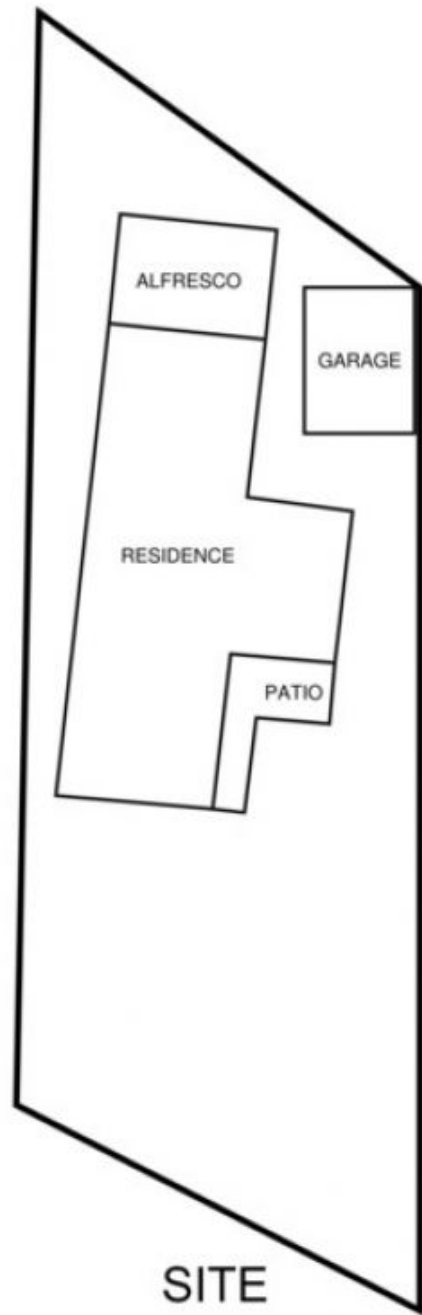

RESIDENCE



# 28 CAPEL AVE CAPEL SOUND

This image is an artistic representation. It is the responsibility of all interested parties to verify all data depicted and omitted.