



4 Yera Crescent RYE VIC

3  1  1 

Epitomising what a beach house by the sea is all about is this little gem, quietly situated near the back beaches of our famed Peninsula. Boasting tranquil outlooks of the Moonah trees and a host of natives that envelope the area, this property is a fabulous coastal retreat or relaxing permanent home.

Featuring:

Sitting elevated on a private allotment where the native trees provide a wonderful backdrop for the Peninsula lifestyle

Three good-sized bedrooms

Light-filled living area which feeds off the kitchen

Land Size : 622 sqm

View : <https://www.ypa.com.au/7393178>



Jade Springer
0437 410 791

INTERNAL LIVING AREA
APPROX: 9.8 SQUARES

PORCH AND DECKS
APPROX: 2.1 SQUARES

CARPORT, WORKSHOP AND STORAGE
APPROX: 9.8 SQUARES

TOTAL AREA
APPROX: 21.7 SQUARES

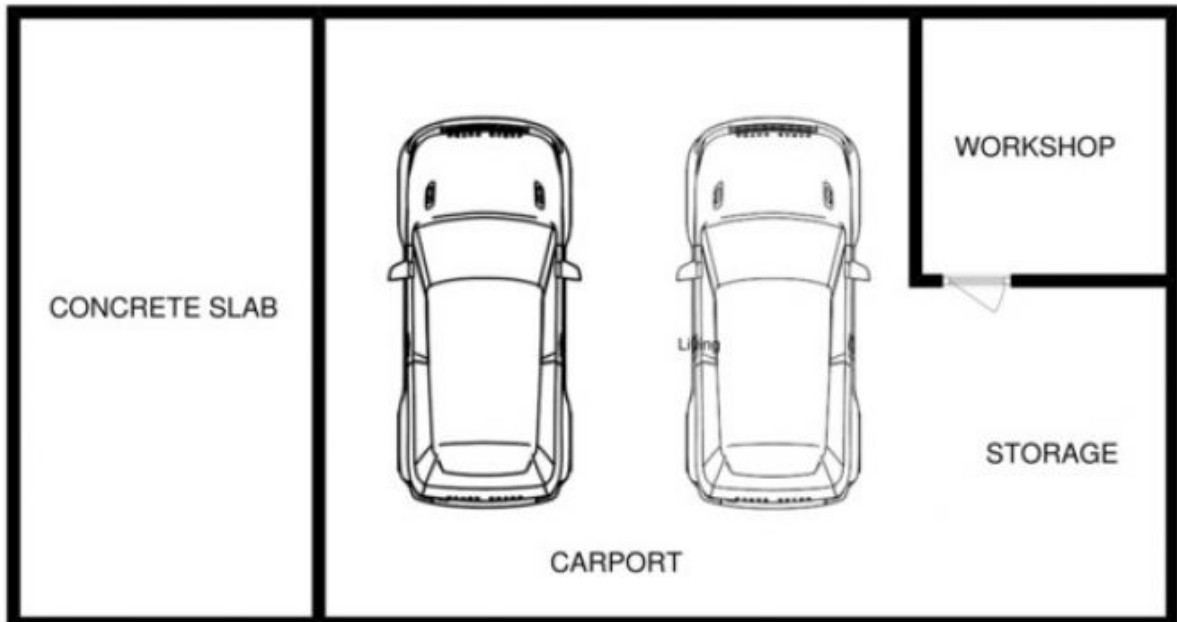

4 YERA CRES RYE

This is an artistic representation. All measurements, dimensions and illustrated areas are approximate. It is the responsibility of all interested parties to verify all data depicted and omitted.