



3 Eva Street RYE VIC

3 2 2

Set on a beautifully elevated allotment of 1500sqm approx with lovely tree top views and bay glimpses, this sweet coastal abode will make you feel right at home from the moment you step through the door.

The two great sized living areas plus billiards room make for perfect open entertaining spaces for large family gatherings or separate living zones for adults and kids whilst the huge open grassed areas to the front and rear of the home will appeal to the keenest of gardeners, party hosts or backyard cricket stars alike!

Not to be overlooked, location is the cherry on top of this already sensational opportunity to own a slice of the Mornington Peninsula. Located within minutes of the sparkling Tyrone Foreshore, Rye Village, Primary School, Yacht Club and recreational reserves - from this position

Land Size : 1509 sqm

View : <https://www.ypa.com.au/7393189>



Tony Talarico
0420 778 401

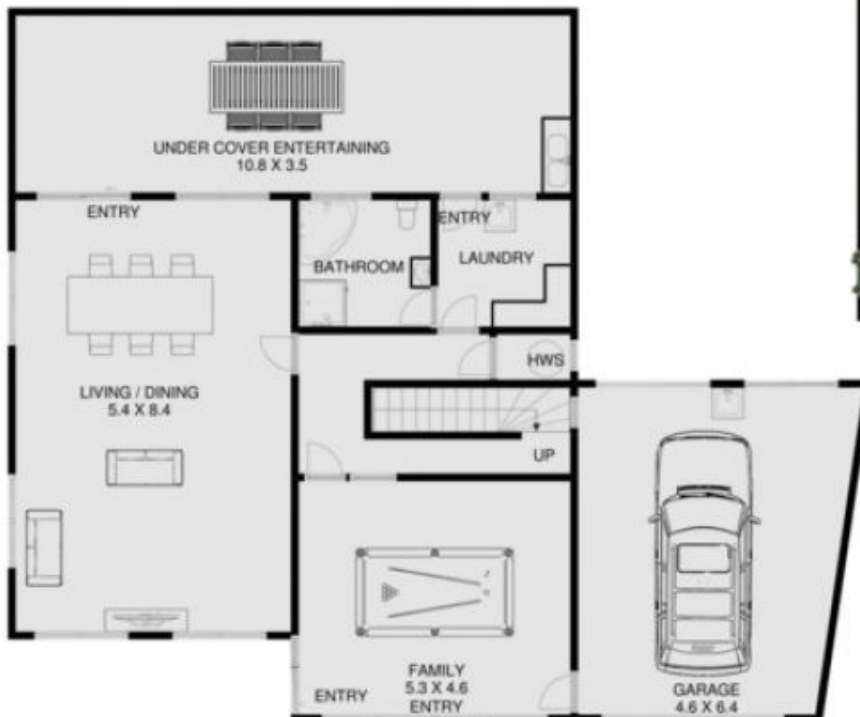

NOT ACTUAL POSITION

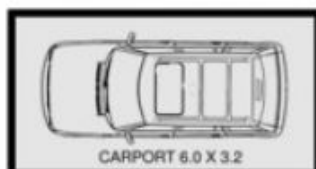

INTERNAL LIVING AREA
APPROX: 15 SQUARES

PORCH AND DECKS
APPROX: 6 SQUARES

GARAGE
APPROX: 4 SQUARES

TOTAL AREA
APPROX: 25 SQUARES

3 EVA STREET RYE

This is an artistic representation. All measurements, dimensions and illustrated areas are approximate. It is the responsibility of all interested parties to verify all data de