



191 Melbourne Road RYE VIC

4  2  1 

Priced to sell, this well presented home is conveniently located and provides options for the home buyer, investor or holiday maker.

Land Size : 876 sqm

View : <https://www.ypa.com.au/7393196>

The main entry flows to the open planned living space and recently updated kitchen with a stainless steel 900ml oven, ideal for family entertaining. The bedrooms are spacious, the master bedroom is serviced by an ensuite. There is also a study/ dressing room or 4th bedroom, the options are yours.



Tony Talarico
0420 778 401

Both living areas open out to the extensive deck overlooking the large rear garden which makes for perfect entertaining on those warm summer days.

On the lower level, there are even more options with the completely separate self-contained quarters consisting of a



SITE

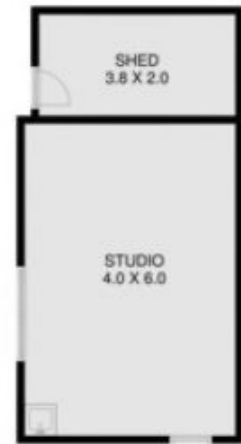

STUDIO



LOWER LEVEL



MAIN LEVEL

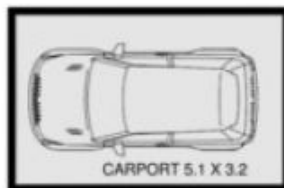
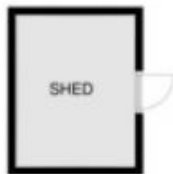

INTERNAL LIVING AREA
APPROX: 18.7 SQUARES
PORCH AND BALCONY
APPROX: 3.3 SQUARES
CARPORT, STUDIO AND SHEDS
APPROX: 5.8 SQUARES
TOTAL AREA
APPROX: 27 SQUARES

191 MELBOURNE ROAD RYE

This is an artistic representation. All measurements, dimensions and illustrated areas are approximate. It is the responsibility of all interested parties to verify all data depicted and omitted.