



39 Landscape Drive HILLSIDE VIC

5 3 2

Not only is this bursting with street appeal, but step inside and the WOW factor shines from front to back! With soaring high ceilings on entrance as you walk through you'll continue to be impressed with the quality of this grand family home.

Offers 4 generous bedrooms with BIRs plus a study, including TWO master bedrooms with ensuite and robes, large kitchen with ceasar stone bench-tops and SS appliances adjoining spacious meals/open living zone, plus a separate formal lounge and dining area.

Also including a generous upstairs retreat with the option to potentially convert this into a 5th bedroom. Outside you'll find a flattering enclosed under cover entertainment area, perfect all year round.

Land Size : 701 sqm
View : <https://www.ypa.com.au/7394612>



Kayla Ridolfi
0421 866 494



First Floor



39 Landscape Drive, Hillside

All dimensions and data on this floorplan sketch are approximate

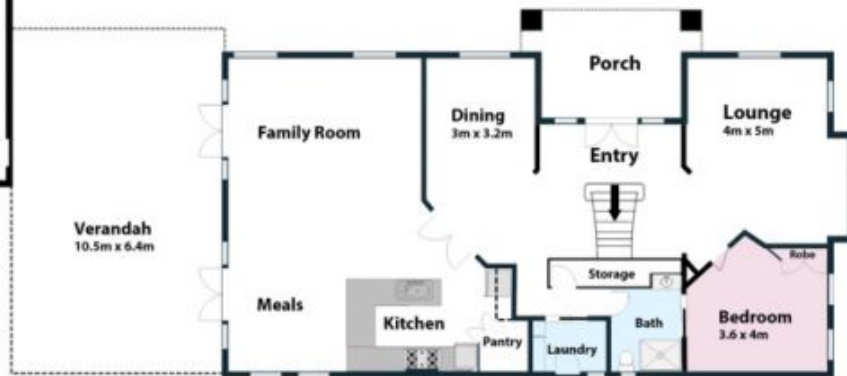

Ground Floor