



48-50 Fig Street DROMANA VIC

6 2 2

Sitting on a sizeable coastal allotment, this holding occupies a double block of 1207sqm*. There is also the bonus of the six bedroom home which could allow you to generate income whilst your plans await approval (STCA).

Land Size : 1207 sqm

View : <https://www.ypa.com.au/7395324>

Featuring:



Elke Remscheid
0423 211 315

Sprawling land parcel of approximately 1207sqm*

Separately titled comprising of two blocks each approximately 603sqm* in size

Close in position just minutes from the beach, schools, shops and amenities

Option to either further capitalise on the large home or develop into a multi-unit site (STCA)

The possibility for lucrative returns given the size of the land holding (which could house 4 townhouses/ units)

Existing home was built in two stages to present as almost



48 FIG ST DROMANA

This image is an artistic representation. It is the responsibility of all interested parties to verify all data depicted and omitted.

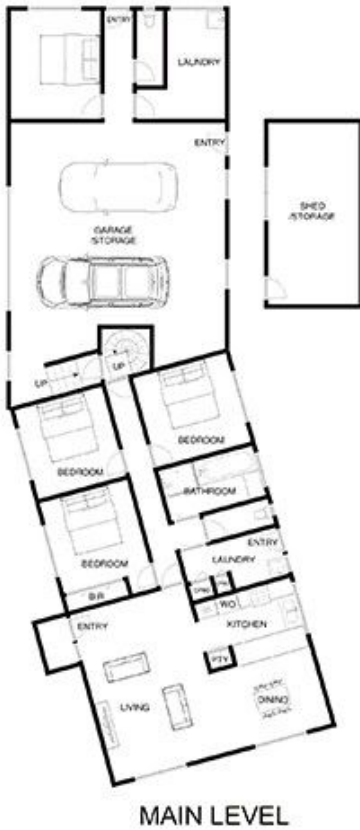

48 FIG ST DROMANA

This image is an artistic representation. It is the responsibility of all interested parties to verify all data depicted and omitted.