



flinders
Judge & Papaleo



2/45-47 Palmerston Street MELTON VIC

2  **1**  **2** 

Set in a quiet tree-lined street within walking distance to High Street, this charming residence exudes a fresh, yet homely feel and is not only low maintenance, but well maintained throughout. The open plan living feels spacious and welcoming, serviced by a modern kitchen sure to impress featuring stainless steel appliances, contemporary white cabinetry with ample cupboards and bench space. The floor plan is well thought out with the robed second bedroom positioned off the hallway, whilst the master is good size with access to the bathroom. Other inclusions that add comfort and convenience list as; gas ducted heating, two split systems and single garage with remote control. The property is ideally suited to first-home buyers, couples, seniors, investors or young families not looking for a large block, but a low-maintenance garden and delightful home with virtually nothing to do but move in and enjoy. Under instructions from FTL Judge and Papaleo Pty Ltd

Land Size : 270 sqm
View : <https://www.ypa.com.au/7398867>



Vickie Ramon
0403 194 621

Unit 2 45/47 Palmerston Street, Melton

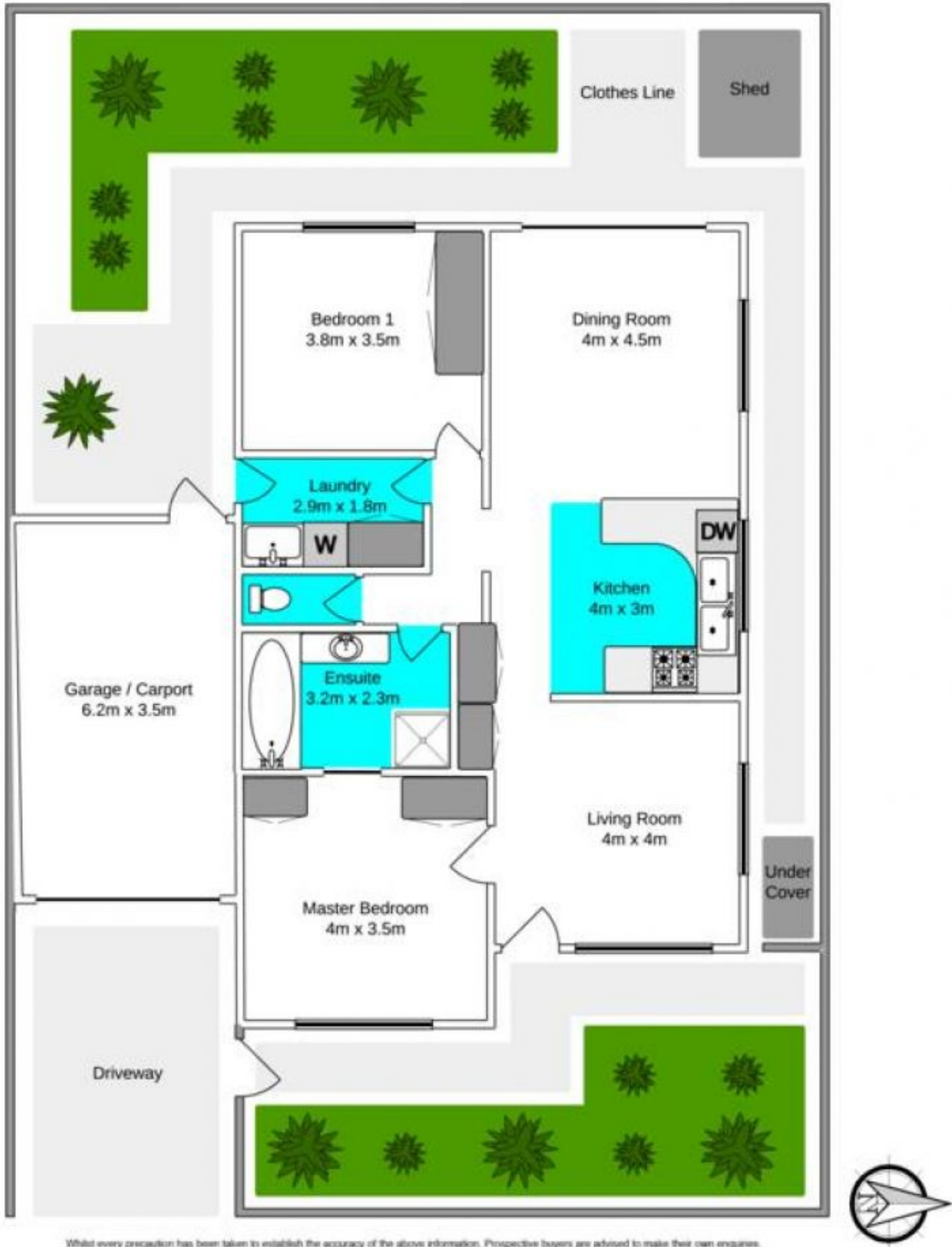

Whilst every precaution has been taken to establish the accuracy of the above information, Prospective buyers are advised to make their own enquiries.