



## 31 Tern Court MELTON VIC

3 2 1

Location provides the perfect context for this stunning 3 bedroom home. Gleaming street appeal and abundant northern light enhance an appealing living area which is accompanied by stunning kitchen with lots of cupboard space. Boasting three double bedrooms, each with built-in robes (Master with semi ensuite), immaculate bathroom and a large living room great for entertaining. Moving outside just gets better as all the hard work has been completed with in-ground resort style pool and two entertaining areas great for completing this fine package. Located close to all amenities and walking tracks this home is one certainly not to be missed. Avoid disappointment, as inspections are our pleasure!!

**Land Size** : 581 sqm

**View** : <https://www.ypa.com.au/7398921>



**Shane Spiteri**  
0488 980 115

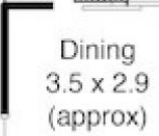
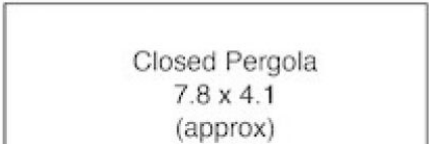
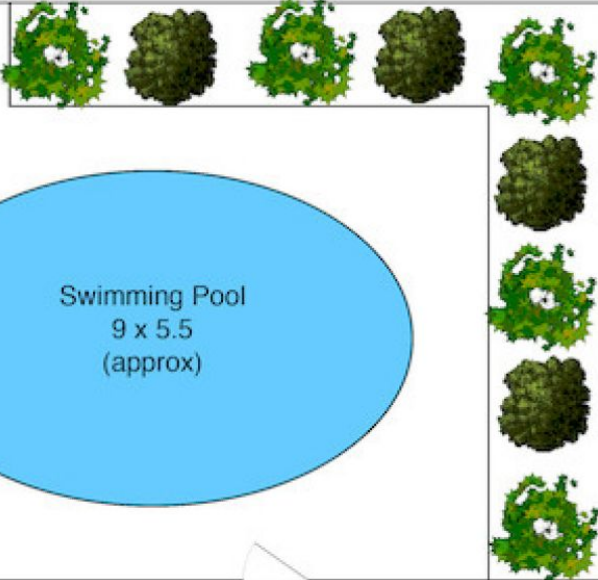
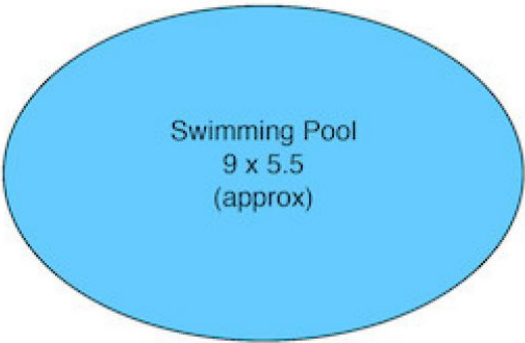

Garage

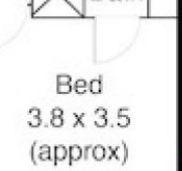
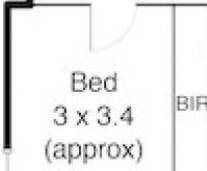

Drive Way

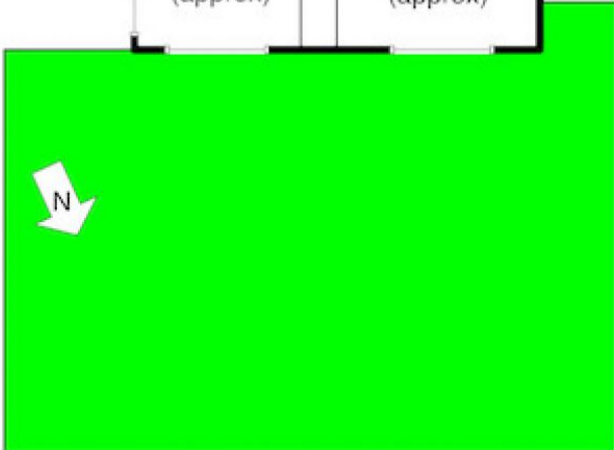

Tern Court