



17 Barleycorn Place MELTON WEST VIC

3 1 2

This family home situated in popular Melton West set on a 703m² allotment (approx.) comprising of three bedrooms, central bathroom, well-appointed kitchen with gas cooking, good sized meals area and large lounge room and family room, added extras include gas heating & evaporative cooling. An outside entertaining area with is the perfect combination for all year round enjoyment. The double garage is perfect for the car enthusiast completes this fine package. This rare property is located close to schools, public transport & Woodgrove shopping centre, certainly a great opportunity exists for one lucky party to nest or invest in this sought after area. Inspections are our pleasure.

Land Size : 703 sqm

View : <https://www.ypa.com.au/7398931>



Vickie Ramon
0403 194 621

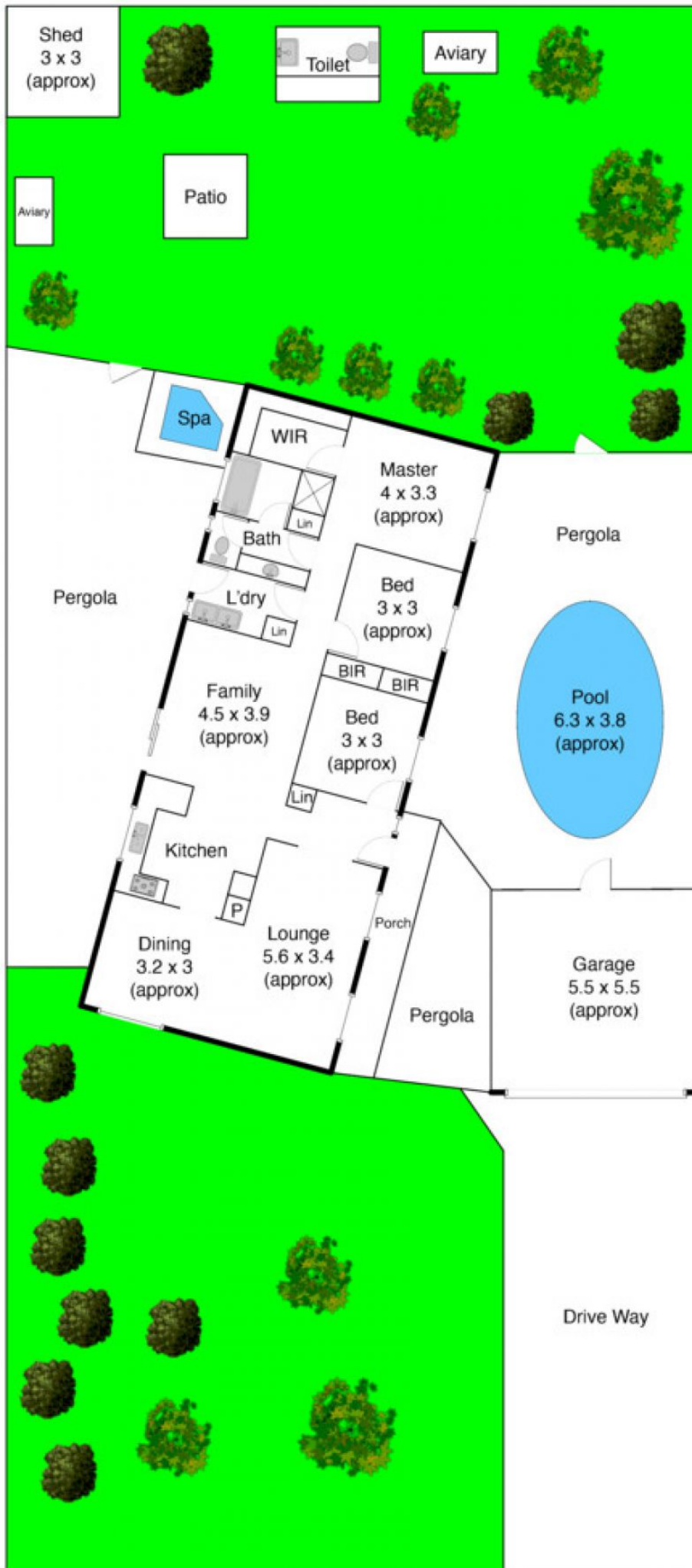

Barleycorn Place