



1-3 Wolfe Road MELTON VIC

3  2  4 

Where can you find such a promising site like this one in the heart of Melton positioned perfectly for re-development? Offering over 1175m² of prime residential land this unique property is ideal for the passive investor or large family, the home has 3 bedrooms ensuite and walk in robe to main bedroom good size lounge, great size sunroom, in ground swimming pool also a self-contained granny flat, double remote control garage with workshop. An inspection will not disappoint.

Land Size : 1175 sqm

View : <https://www.ypa.com.au/7398933>



Vickie Ramon
0403 194 621

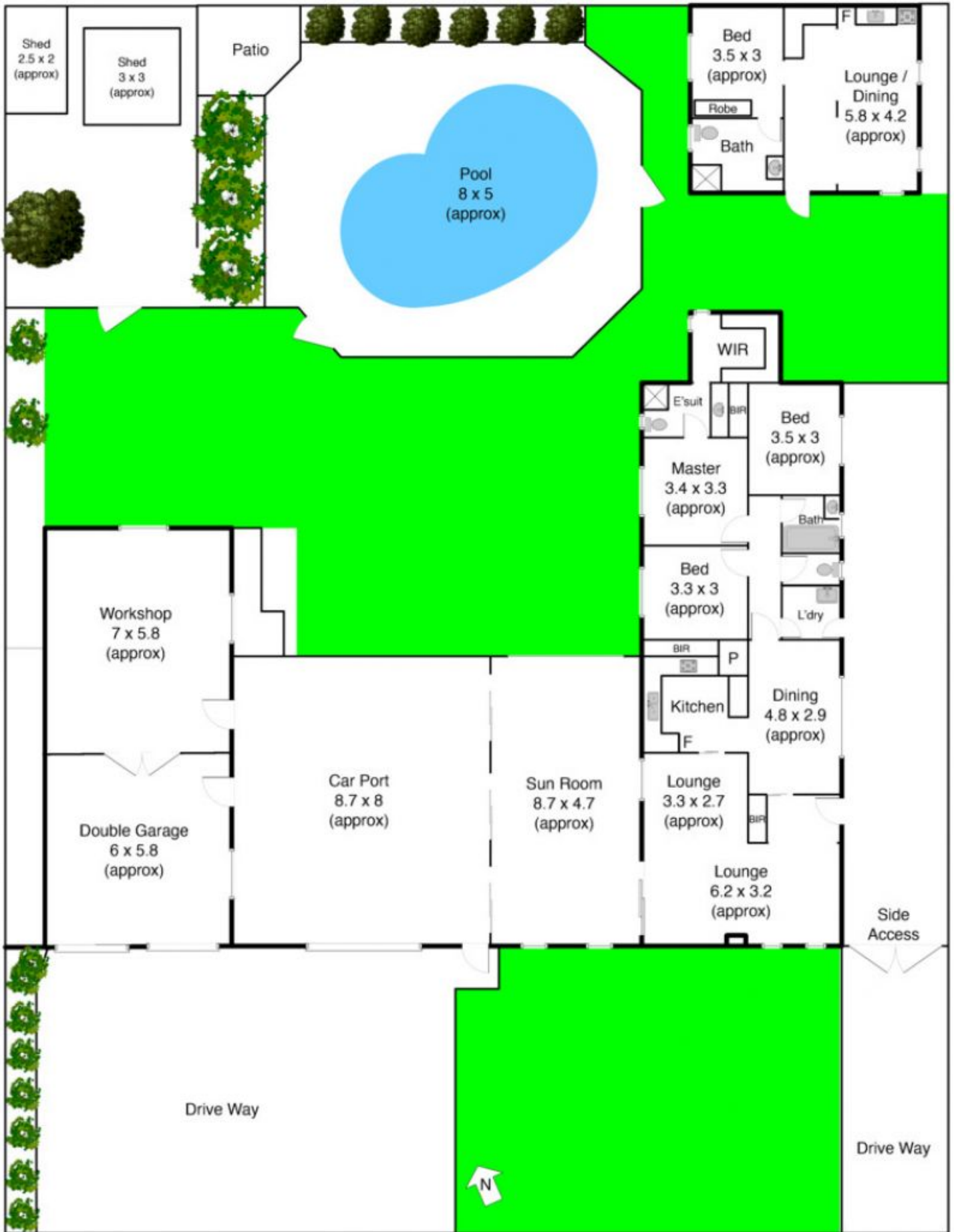

Wolfe Rd