

5 Liberty Court BROOKFIELD VIC

4  2  6 

Positioned in the highly sought after Brookfield Estate on 720m² (approx.) of land, this amazing Porta Davis home is finished to the highest quality & standards. Comprising of four bedrooms, two bathrooms, open gallery style kitchen with walk in pantry, stone bench tops and 900mm upright stainless steel oven, the spacious meals area overlooks the family domain, while still offering a separate & spacious lounge room/kids retreat, entertaining is well covered with the huge under roof alfresco area. The long list of inclusions include, cooling, gas ducted heating, alarm system, LED down lights throughout, Spotted Gum flooring to living areas finish off this amazing home. Moving outside all the work has been done with an oversized garage with drive through access straight to a huge shed 6.6 - 12mtrs approx., exposed aggregate concrete to front & extensive concreting and landscaping from front to rear. Truly a home that is desired by all, avoid disappointment as inspections

Land Size : 720 sqm

View : <https://www.ypa.com.au/7398953>



Shane Spiteri
0488 980 115

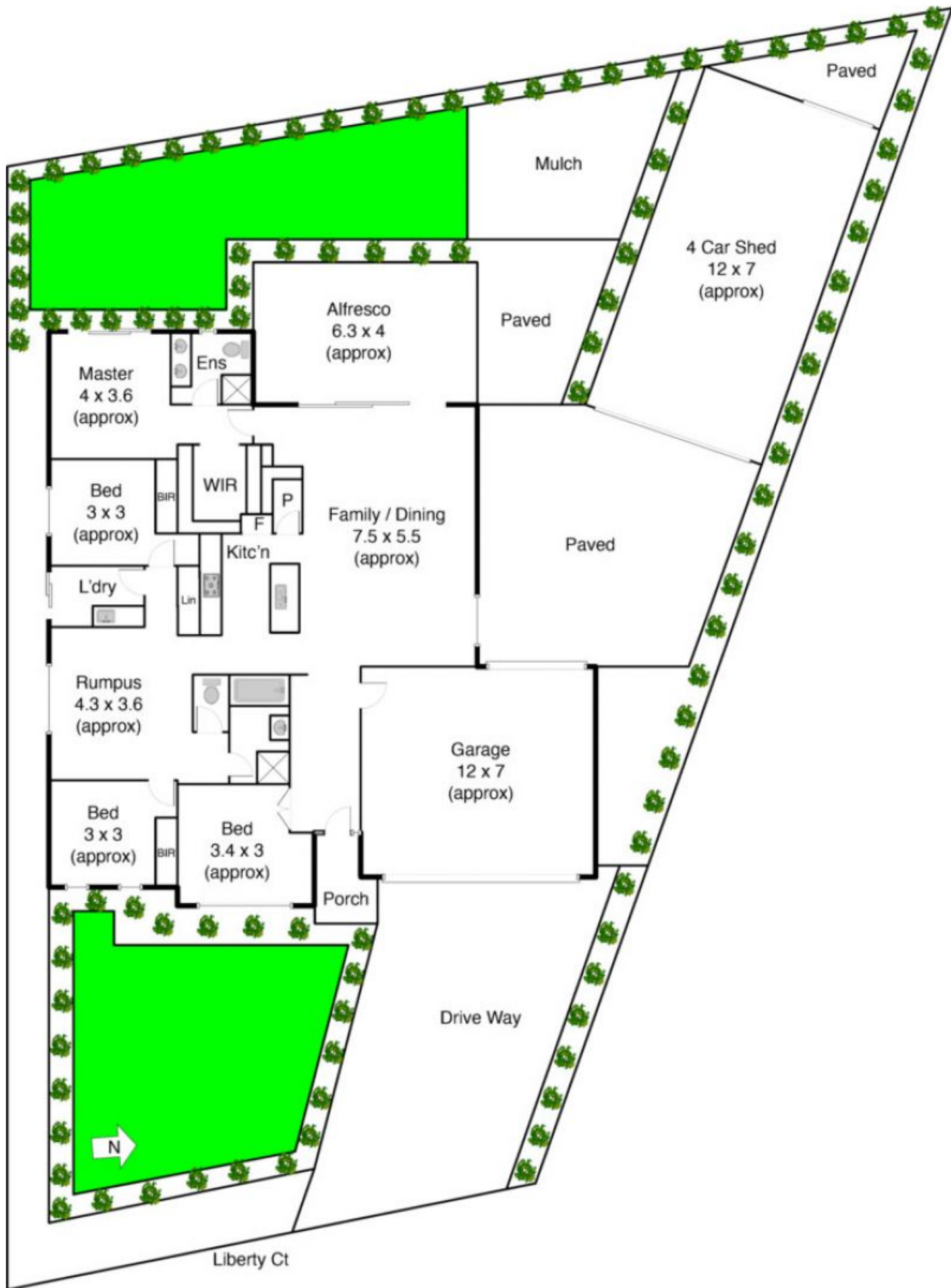

Paved

Mulch

4 Car Shed
12 x 7
(approx)

Alfresco
6.3 x 4
(approx)

Paved

Master
4 x 3.6
(approx)

Ens

Bed
3 x 3
(approx)

WIR

Family / Dining
7.5 x 5.5
(approx)

Paved

L'dry

Kitc'n

Rumpus
4.3 x 3.6
(approx)

Garage
12 x 7
(approx)

Bed
3 x 3
(approx)

Bed
3.4 x 3
(approx)

Porch

Drive Way

N

Liberty Ct