



37 Cromarty Circuit DARLEY VIC

3 2 2

Brilliantly situated in the renowned Darley Estate this ideal residence is what you have been waiting for. Comprising of three large bedrooms (master with walk in robe and full ensuite), this fabulous designed home includes large open plan living and meals area with a separate formal living area. Appointed with a long list of extras, ducted heating/cooling, established landscaped gardens, stunning pergola area great for entertaining, double garage with drive through access and more! This immaculate home is sure to impress, avoid disappointment and act quickly. Inspections are truly our pleasure.

Land Size : 410 sqm

View : <https://www.ypa.com.au/7398974>



Shane Spiteri
0488 980 115

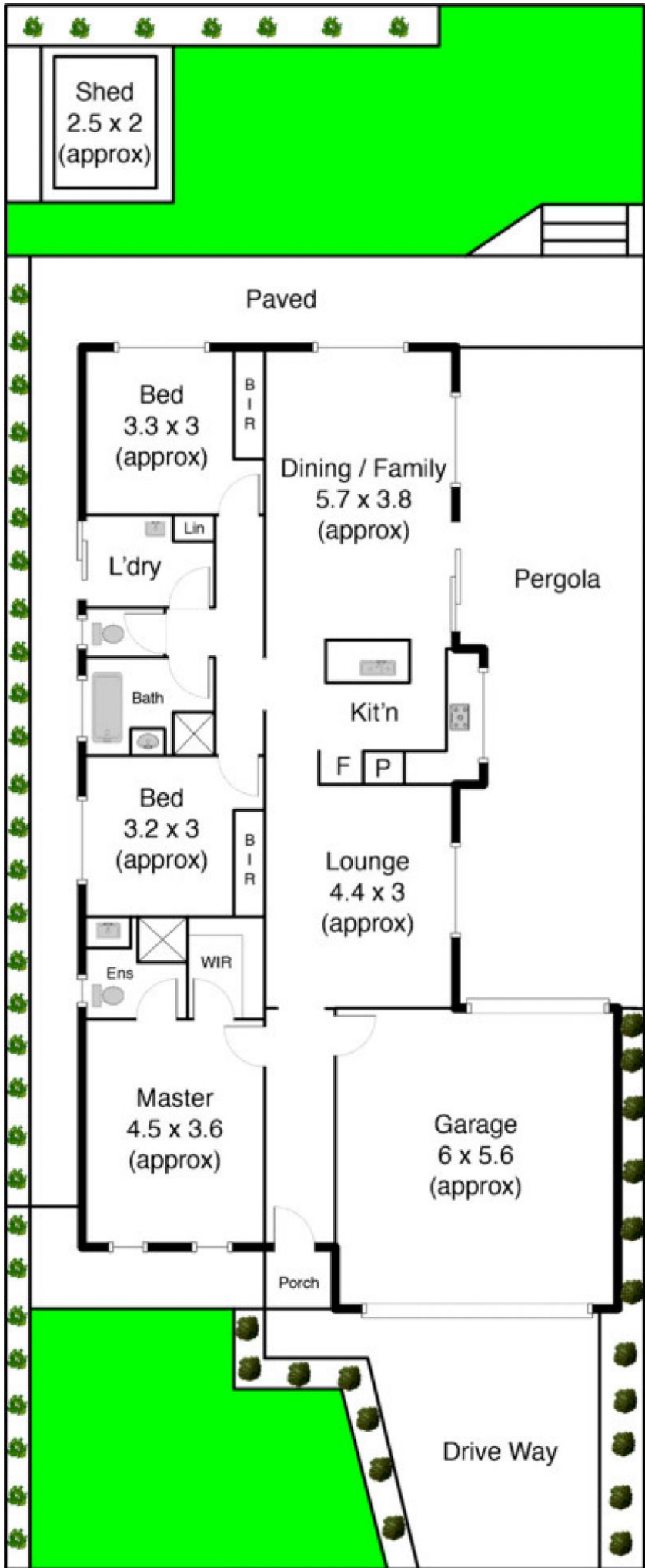

Shed
2.5 x 2
(approx)

Paved

Bed
3.3 x 3
(approx)

B
I
R

Dining / Family
5.7 x 3.8
(approx)

L'dry

Lin

Bath

Bed
3.2 x 3
(approx)

B
I
R

Kit'n

F

P

Lounge
4.4 x 3
(approx)

Ens

WIR

Master
4.5 x 3.6
(approx)

Garage
6 x 5.6
(approx)

Porch

Drive Way

Cromarty Crt