



## 16 Curlew Close MELTON VIC

3  1  2 

This neat and tidy family home offers you the opportunity to enter the property market at an affordable price. Comprising of 3 generous size bedrooms with BIR, spacious lounge and kitchen with adjoining meals area, central bathroom, heating and cooling and more. Moving outside there is a front porch, lockup garage, garden shed and situated on a 587m<sup>2</sup> (approx) allotment. The property is situated close to schools, and public transport and walking distance to local shops. Call today to organise your inspection.

**Land Size** : 587 sqm

**View** : <https://www.ypa.com.au/7398975>



**Shane Spiteri**  
0488 980 115

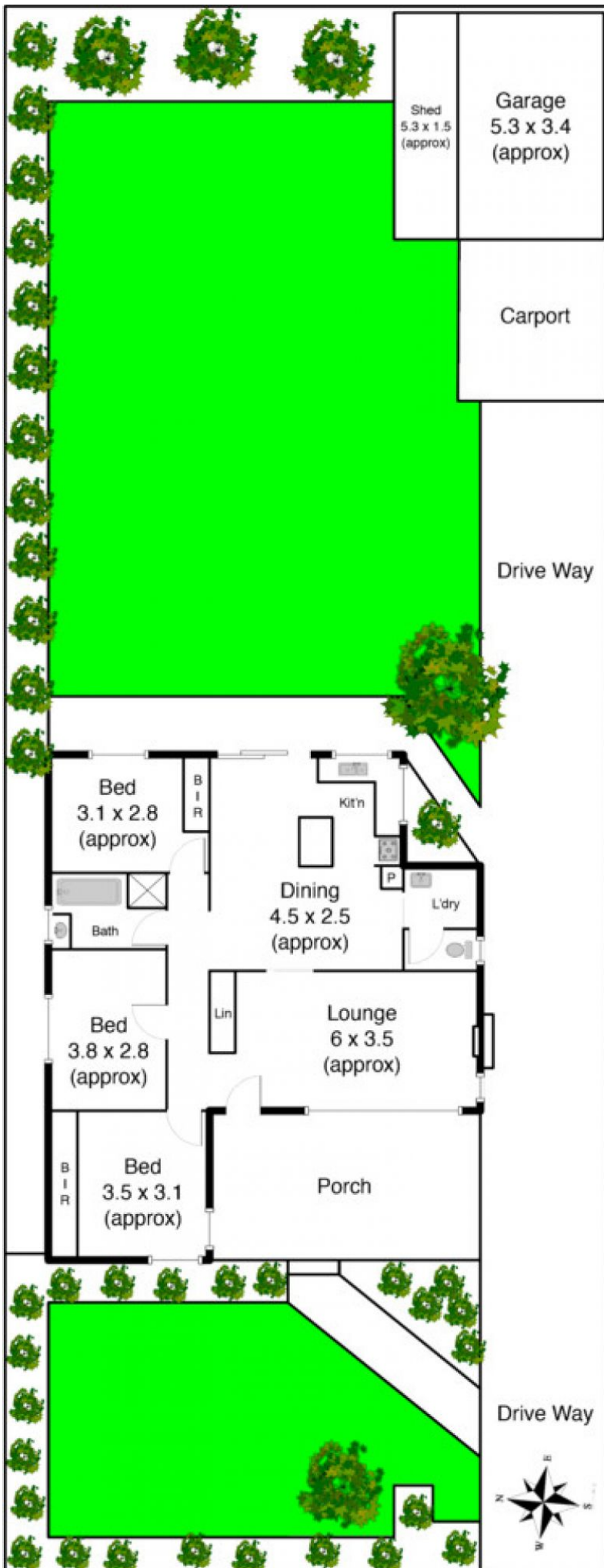

Curlew Ct