

## 103 Long Tree Drive MELTON WEST VIC

4 2 4

Located on a prized location in Arnolds Creek estate, this four bedroom home combines space and style and making it the perfect start to enter the vibrant Melton market or family home. Comprising four bedrooms (main with walk in robe and ensuite) stunning large open plan living/dining, well equipped kitchen and meals area with stainless steel appliances and ample storage space. Outside features an amazing all year round, fully enclosed entertaining area with stunning landscaped gardens and side access to a huge shed/workshop.

Further features include central bathroom, ducted heating, air conditioning, alarm, double remote garage and side access. Be quick as this home won't be here for long.

**Land Size** : 640 sqm

**View** : <https://www.ypa.com.au/7398998>



**Shane Spiteri**  
0488 980 115

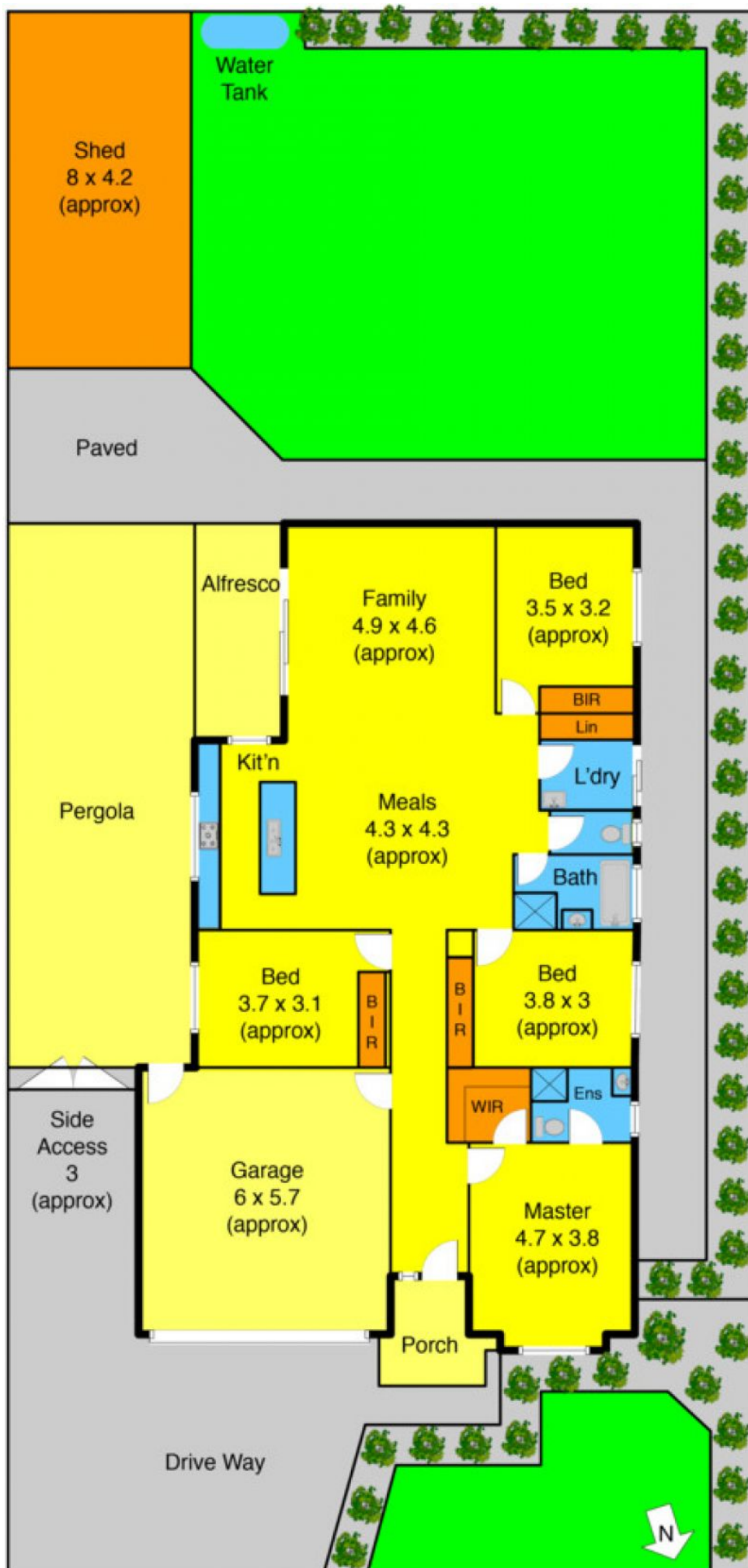

Long Tree Drive