



**99 Longtree Drive MELTON WEST VIC**

4  2  2 

This is living at its very best! With parklands and walking tracks all at your front door, this huge family home sits on the edge of everything great Arnolds creek. Contemporary family residence, grand entrance, quality fixtures and fittings throughout set the high standards to this modern day classic. Comprising: 4 bedrooms with BIR (master boasting WIR and ensuite) forma lounge room, kids retreat/study, spacious open plan living and dining area overlooked by a sleek kitchen complete with breakfast bar. Sliding doors seamlessly combine the inside without revealing a stunning entertainer's alfresco area complete with large space for the kids to play. Additional features include: ducted heating/cooling, ample storage, double remote garage with internal access, fully landscaped garden surrounds and with side access great for the caravan or boat etc. Appreciate quality, call today.

**Land Size** : 640 sqm

**View** : <https://www.ypa.com.au/7399041>



**Shane Spiteri**  
**0488 980 115**

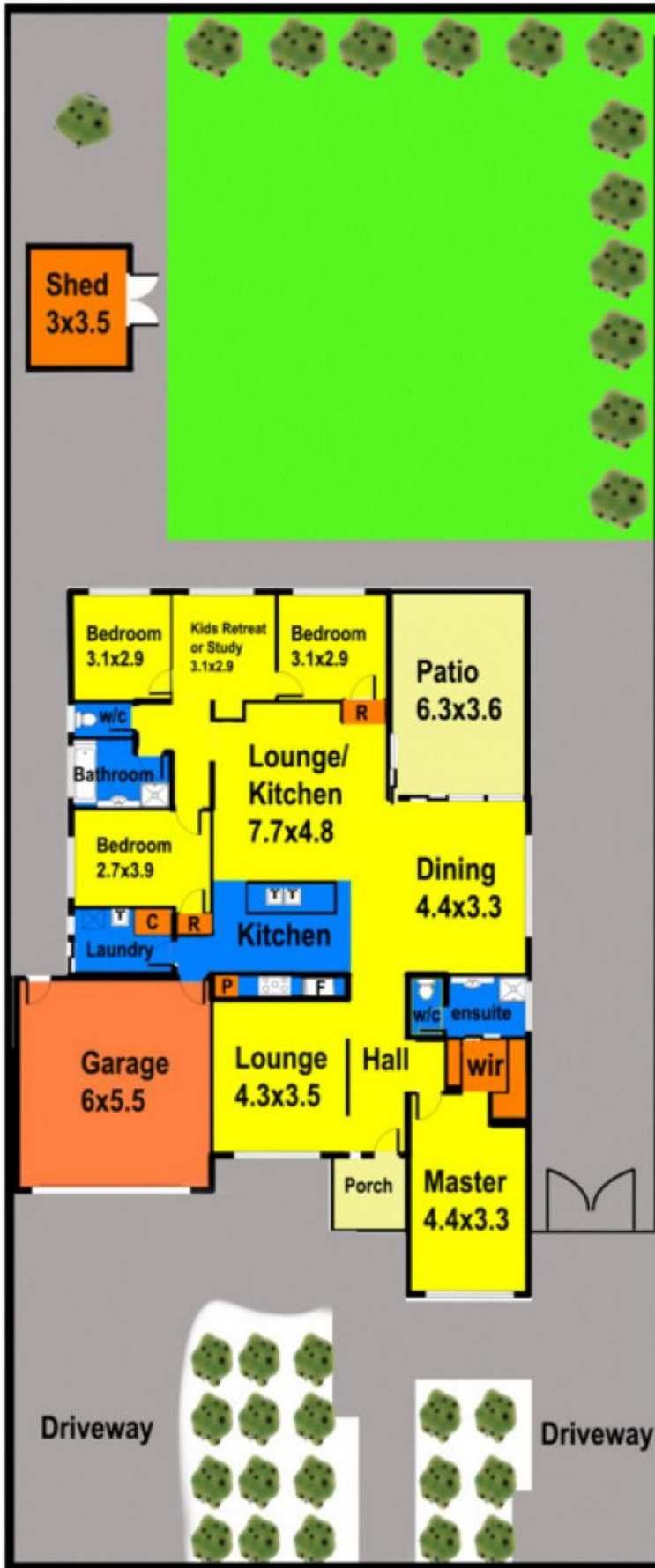

## 99 Longtree Drive

Floor plan measurements are approximate and are for illustrative purposes only. While we do not doubt the floor plan's accuracy we make no guarantee, warranty or representation as to the accuracy and completeness of the floor plan. You or your advisors should conduct a careful investigation of the property to determine your satisfaction as to the suitability for your space requirements.