

# ypa



**15 Paul Harris Drive MELTON WEST VIC**

4  2  2 

Situated in Meltons forever popular Westlake estate, this spacious family home meets every modern priority with ease, elegance and efficiency.

Through double grand entry doors you are greeted with 9ft ceilings and wide hallways, giving you that feeling of space youve been searching for.

Comprising of four generous size bedrooms, (master boasting parents retreat area, WIR and grand ensuite w spa bath, oversized shower and twin vanity), large formal lounge room, central bright bathroom, kids retreat and designer kitchen opening overlooking spacious, light filled open plan living/dining area. Leading outside you are absorbed by easily maintained landscaped surrounds whilst relaxing in your king sized under roof line alfresco area.

Other features of this truly wonderful home include: refrigerated cooling and heating, double remote garage

**Land Size** : 543 sqm

**View** : <https://www.ypa.com.au/7399087>



**Shane Spiteri**  
**0488 980 115**

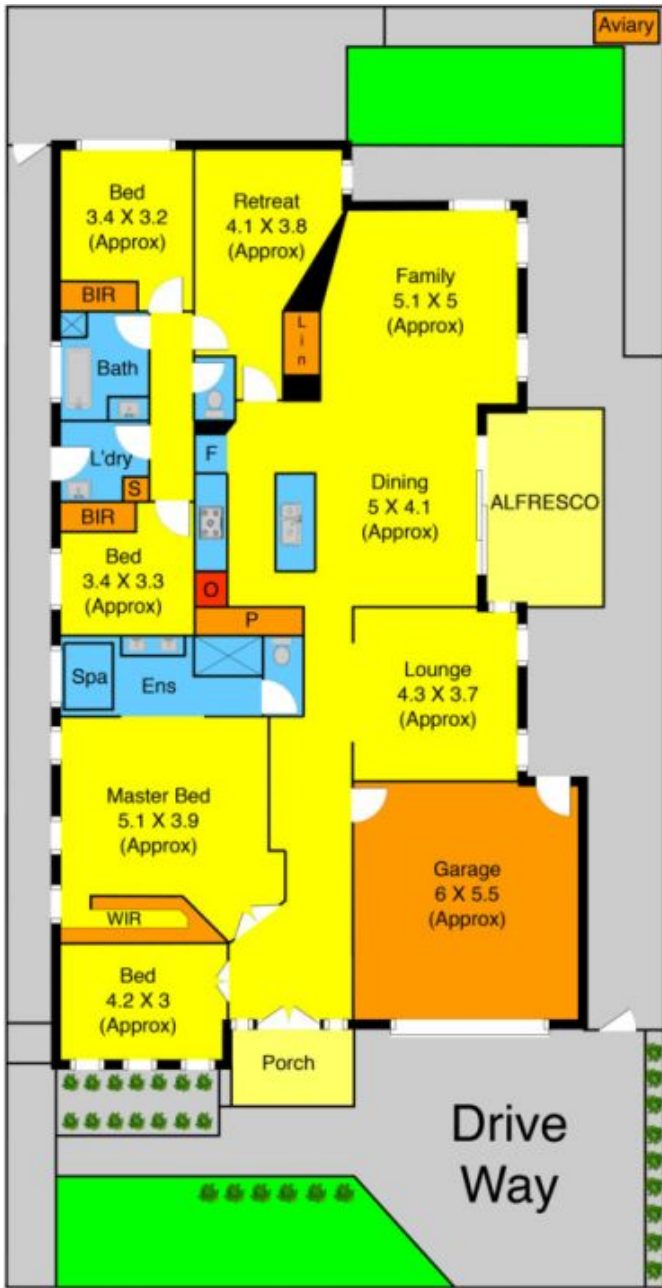

Paul Harris Dr

