



30 Lachlan Road MELTON SOUTH VIC

3  2  4 

This stunning 3 bedrooms plus study home has got everything. Gleaming street appeal and abundant northern light enhance an appealing living area which is accompanied by the kitchen/dining with new stainless appliance and bench tops. Three double bedrooms, each with built-in robes and main with ensuite and walk in robe, immaculate bathroom and two living rooms great for entertaining. Huge four car garage links beautifully with the generous, landscaped outdoor spaces adds complete comfort and walking distant to shops, schools and transport. Call before its too late

Land Size : 586 sqm

View : <https://www.ypa.com.au/7399102>



Shane Spiteri
0488 980 115

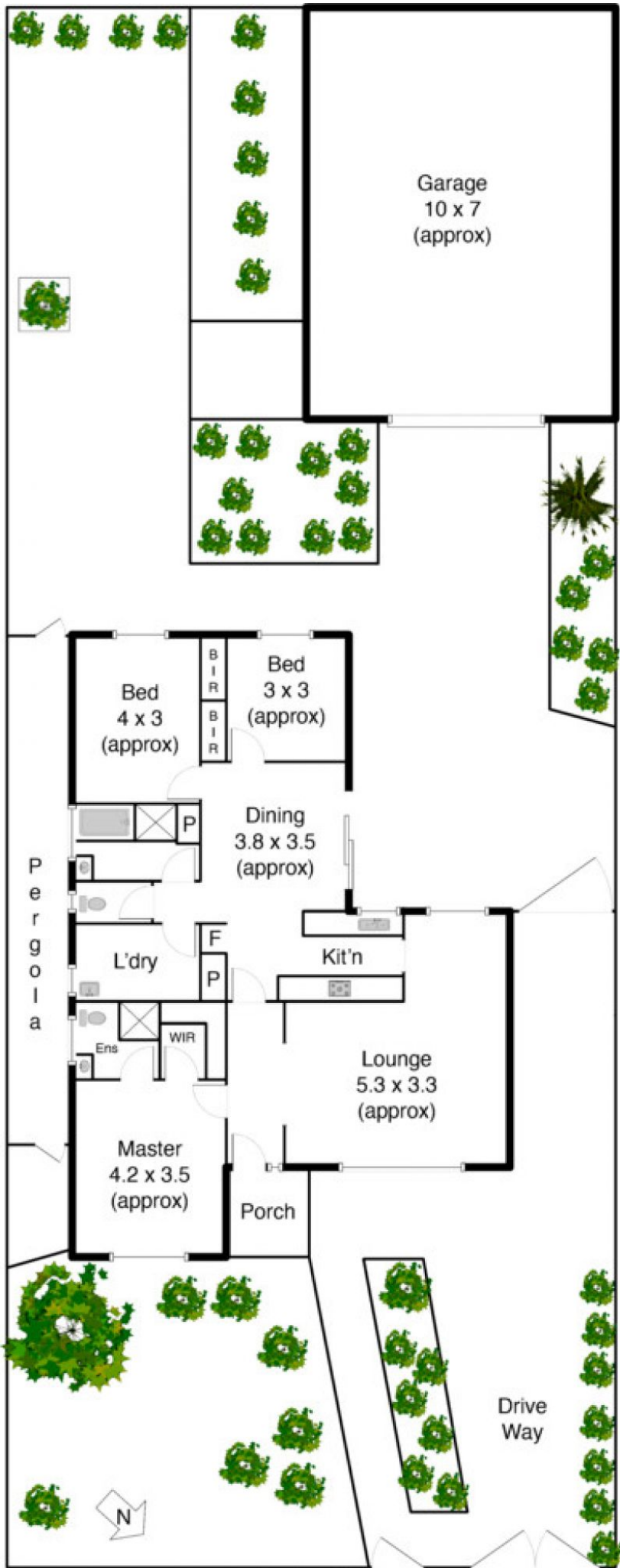

Iachlan Rd