

9/15-17 Crestmont Drive MELTON SOUTH VIC

3 **1** **1**

Ideal for an investment or first home, this modern day property offers exceptional value located within walking distance to Melton Train Station. Comprising of three bedrooms all with built in robes, along with a large open plan Kitchen, Meals and Family area makes this the perfect first home for someone looking to break into the market or even add another home to your portfolio. Along with a single garage and an extra parking bay, this property will not last long so call today to arrange an inspection.

View : <https://www.ypa.com.au/7399105>



Vickie Ramon
0403 194 621

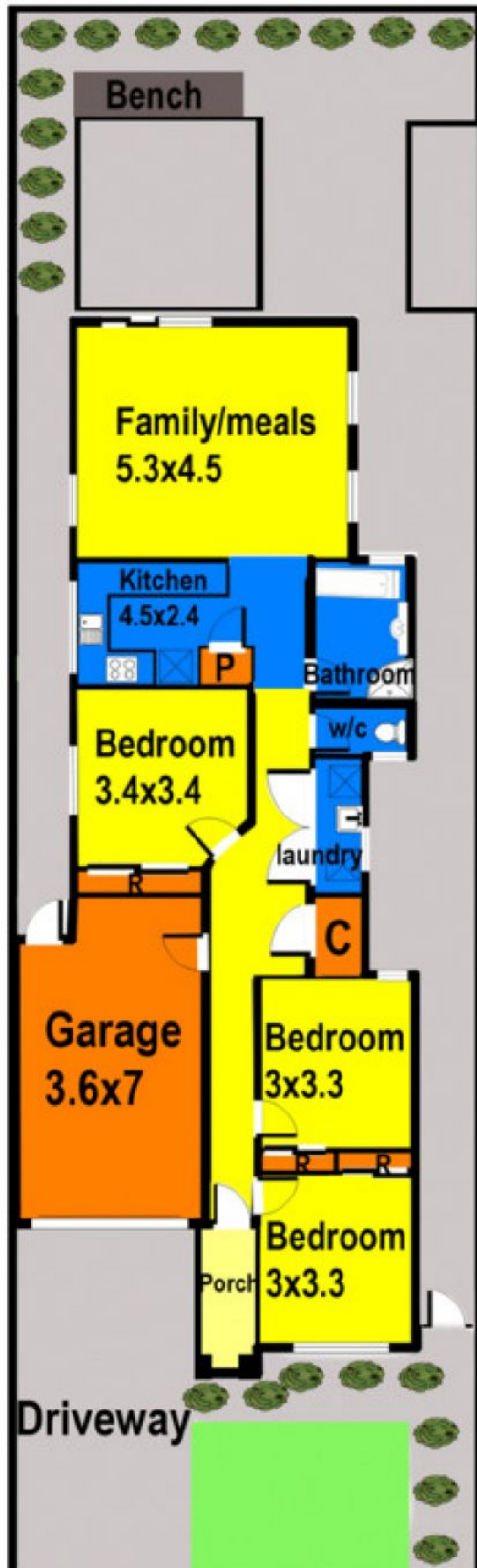

9/15-17 Crestmont Dve Melton South

Floor plan measurements are approximate and are for illustrative purposes only. While we do not doubt the floor plan's accuracy we make no guarantee, warranty or representation as to the accuracy and completeness of the floor plan. You or your advisors should conduct a careful investigation of the property to determine your satisfaction as to the suitability for your space requirements.