

ypa



1/10 Dalray Crescent KURUNJANG VIC

3 2 2

First home, family home or invest with this sleek design and finished with the highest quality this spacious residence is going to be hard to go past. With 3 generous size bedrooms with BIR, master with ensuite and WIR, large spacious lounge with open meals area which leads out to concrete entertaining area. Also includes 9 foot ceilings, window furnishings, ducted heating, evaporative cooling, fully landscaped, concreted throughout and remote garage with internal access. Located close to all amenities schools, transport and shop, call before its too late!!

View : <https://www.ypa.com.au/7399112>



Shane Spiteri
0488 980 115

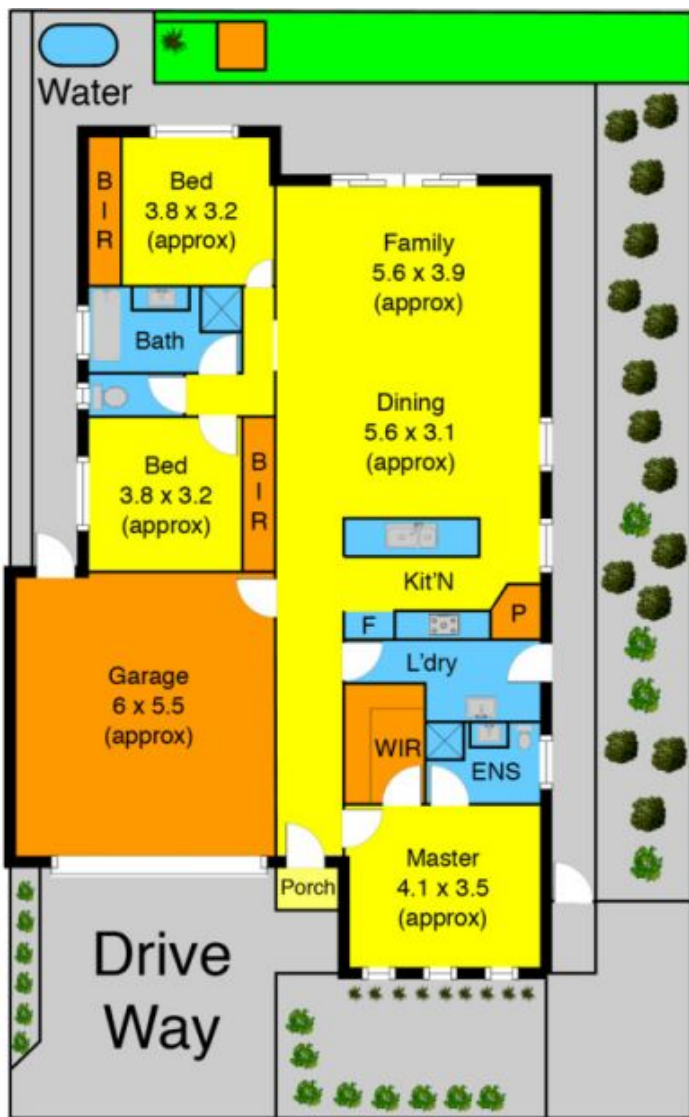

Dalray Cr

