



#### 48 Sovereign Boulevard MELTON WEST VIC

4 2 2

This is living at its very best! With parklands and walking tracks all at your front door, this huge family home sits on the edge of everything great about Sovereign Gardens. Contemporary family residence, quality fixtures and fittings throughout set the high standards to this modern day classic. Comprising: Four bedrooms with built in robes, master boasting WIR and ensuite with double vanity, large formal lounge room, separate theatre room and spacious open plan living and dining area overlooked by a sleek kitchen complete with two pack cupboards and stainless steel appliances and breakfast bar. Timber doors seamlessly combine the inside with outside revealing a stunning entertainer's alfresco complete with decking and a large space for the kids to play. Additional features include: ducted heating/cooling, ample storage, double remote garage, side access and fully landscaped garden surrounds. Appreciate quality, call today.

**Land Size** : 816 sqm

**View** : <https://www.ypa.com.au/7399115>



**Shane Spiteri**  
0488 980 115

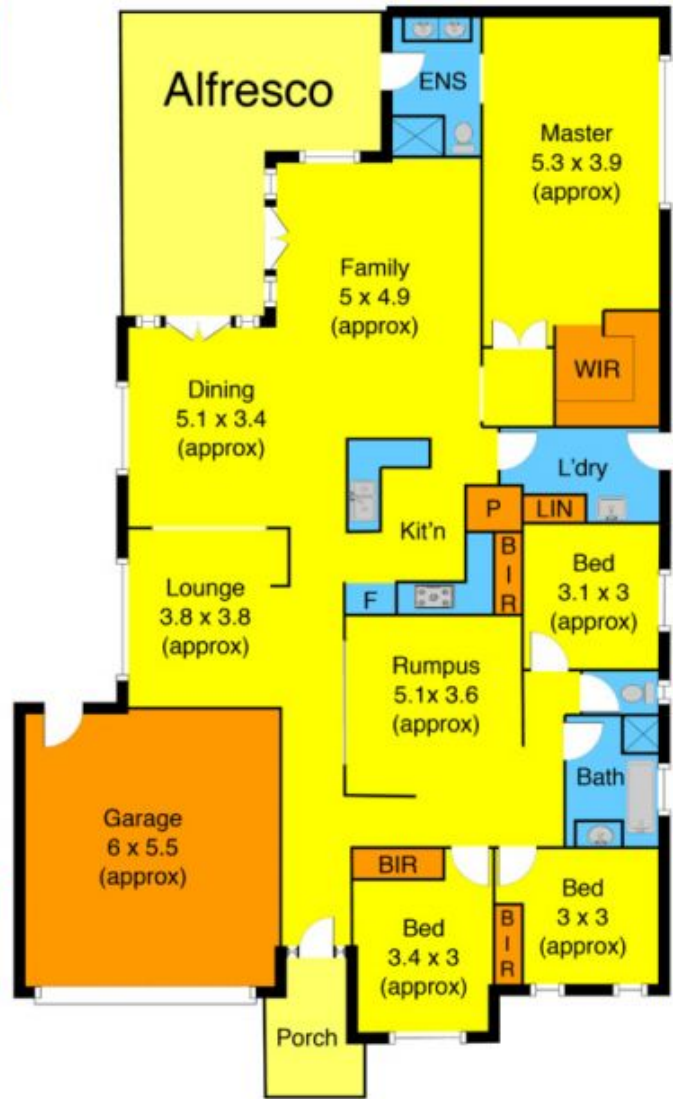

Sovereign Blvd