



## 2 Ascot Place MELTON WEST VIC

3  1  3 

Contemporary design with modern comforts this lovely residence provides three double bedrooms all with built in robes, central located bathroom, stunning kitchen with plenty of cupboard space to accommodate any growing family. A host of extras include 2 living areas/ meals area, heating/cooling and more. Moving outside just gets better with a huge block, garden shed and stunning entertaining area, work shop, water tanks, access to garage and sitting on an allotment of 981m<sup>2</sup> (approx.). Located close to all amenities and walking tracks this home is one certainly not to be missed. Avoid disappointment, as inspections are our pleasure!!

**Land Size** : 981 sqm  
**View** : <https://www.ypa.com.au/7399127>



**Shane Spiteri**  
0488 980 115

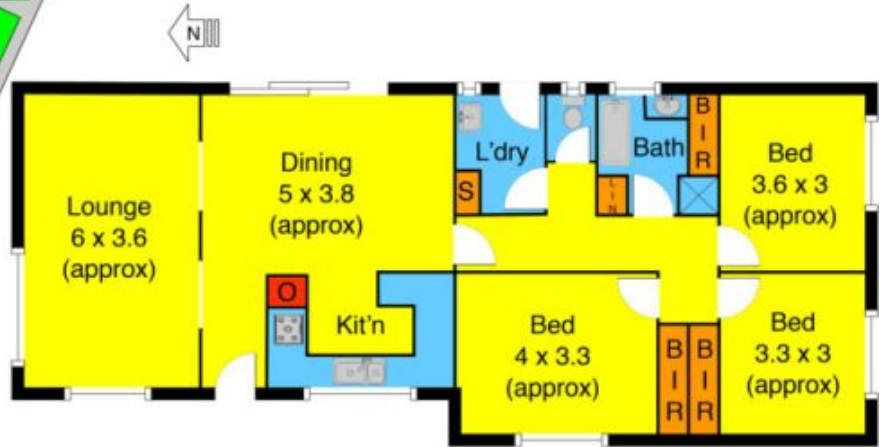

Ascot PI