

# ypa



**2/22 Sovereign Boulevard MELTON WEST VIC**

4  2  2 

Situated in the most sought after Sovereign Gardens estate, this elite built family home on a 500m<sup>2</sup> (approx) block, has all your high end needs, in a location that doesn't get any better, walking distance to all levels of prestige zoned schooling, parks, shopping and community amenities. Comprising of 4 spacious bedrooms, 2 baths, master with full walk in robe, ensuite with oversized shower and double vanity, fully equipped modern kitchen with dishwasher and stainless steel appliances, Other features include double remote garage, ducted heating, split system air condition, tiling throughout, feature hallway niches, high ceilings, alfresco area, garden shed. This property is nestled in Melton's most impressive street and will not last long, call today to arrange your inspection.

**Land Size** : 482 sqm

**View** : <https://www.ypa.com.au/7399130>

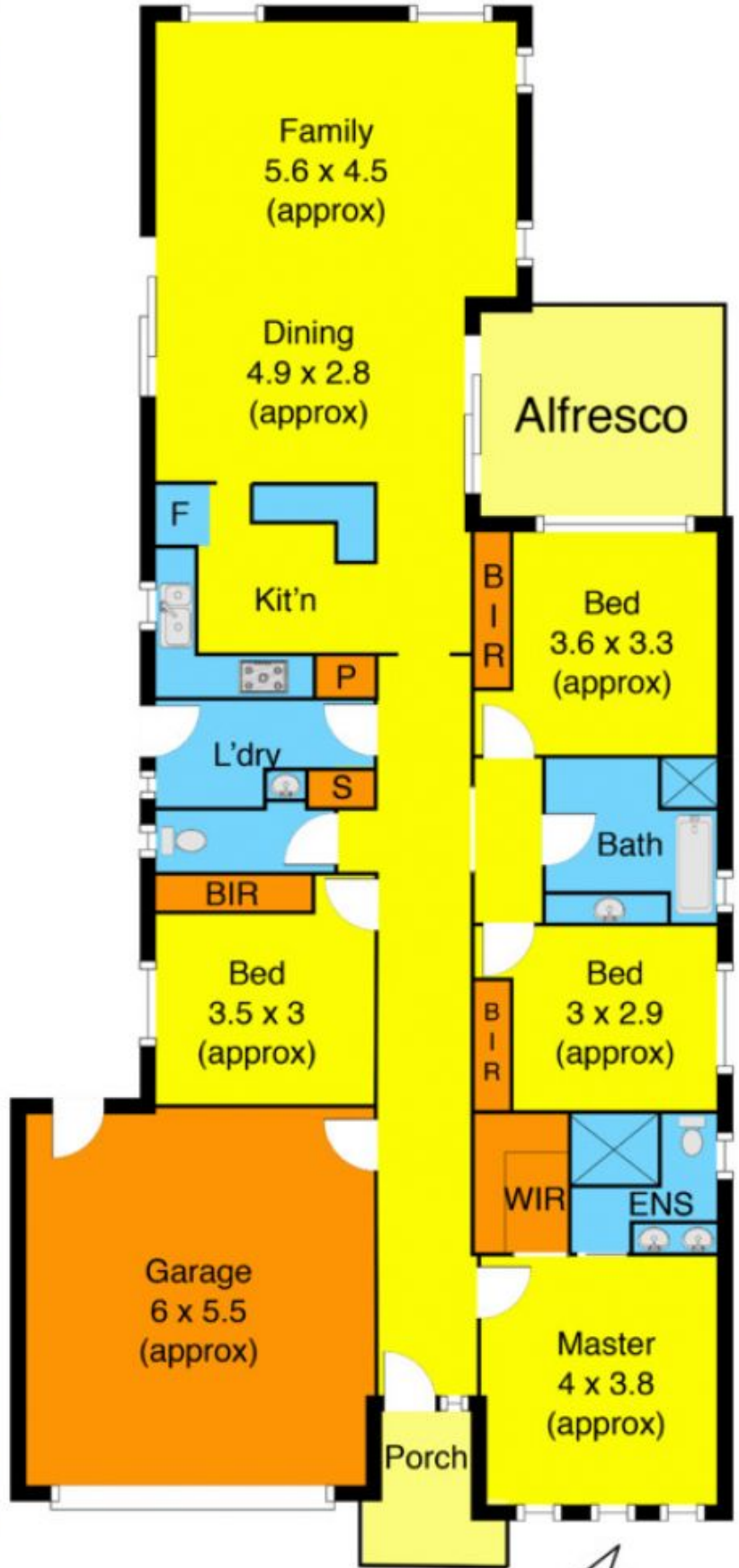
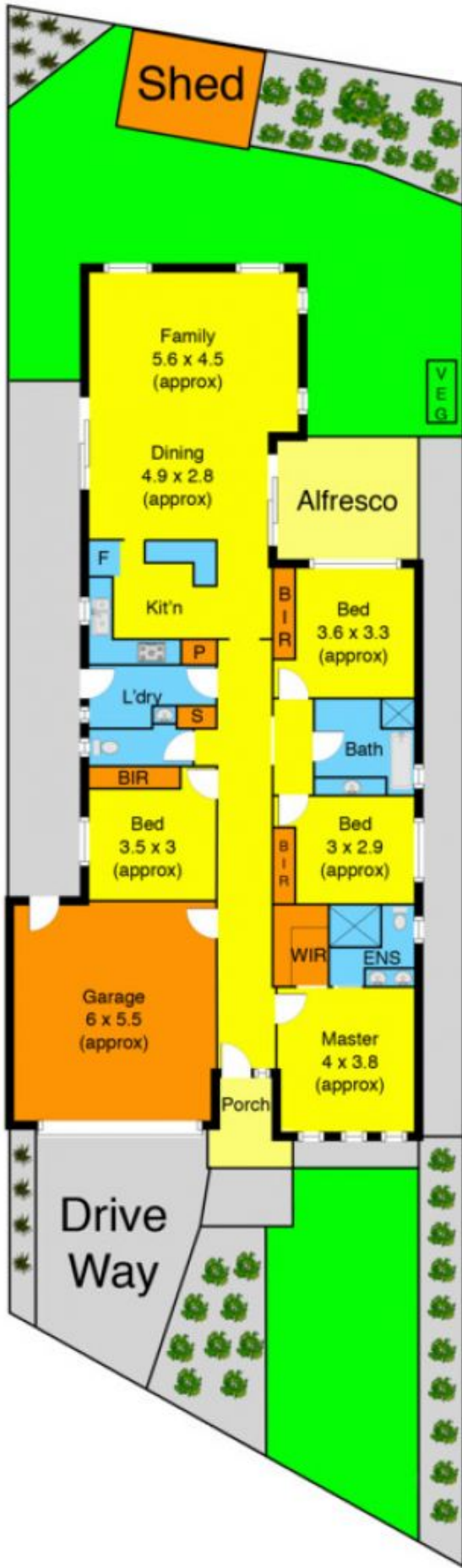

Sovereign Blvd

