



25 Mitchell Road MELTON SOUTH VIC

3  **1**  **1** 

Irrespective of whether you are an investor looking for that perfect portfolio or a buyer looking for a property to call home, this exciting piece of real estate is the one for you, perfectly positioned on a massive 585m² (approx) block, the home has so much character and endless potential. Located within walking distance from Melton train station, medical centres, public transport, brand new shopping district and all levels of schooling, you would be hard pushed to find a more appealing investment location. Comprising of three generous large sized bedrooms, large lounge room plus huge rumpus room with sliding door access to the full landscaped gardens, meals area, fully renovated kitchen with stone benches, dishwasher, expansive storage space and stainless steel appliances, central bathroom, this exclusive home is complemented by a wonderful and modern alfresco with feature down lighting for all your home entertaining needs. Other extras include

Land Size : 585 sqm

View : <https://www.ypa.com.au/7399145>

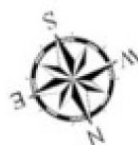
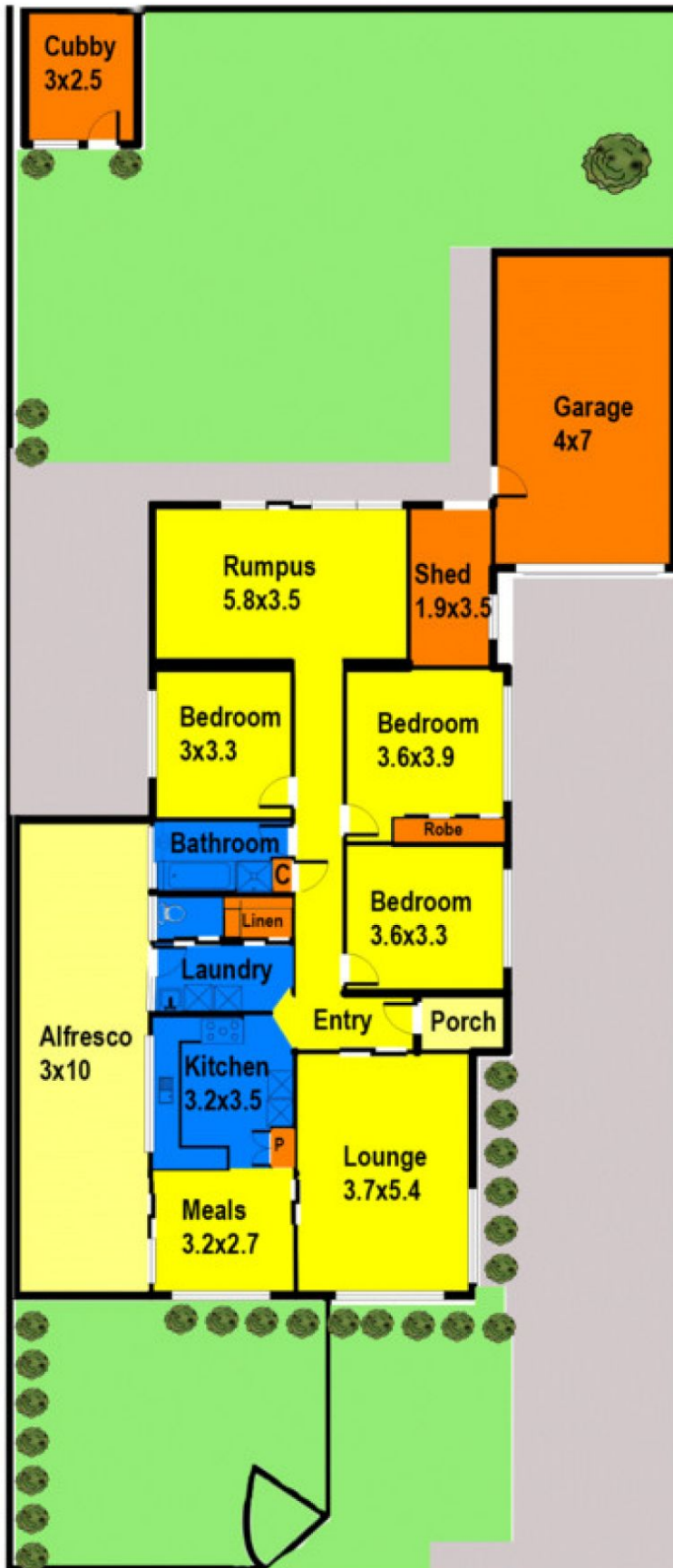

25 Mitchell Road Melton South

Floor plan measurements are approximate and are for illustrative purposes only. While we do not doubt the floor plan's accuracy we make no guarantee, warranty or representation as to the accuracy and completeness of the floor plan. You or your advisors should conduct a careful investigation of the property to determine your satisfaction as to the suitability for your space requirements.