



865 Exford Road EXFORD VIC

3 1 8

Serenity, total privacy, silence and spectacular outlooks, are just some of the attributes that enhance the enjoyment of this lifestyle property.

Exclusive and secluded, this 10 acres approx. estate offers an increasingly rare opportunity to acquire a flexible acreage situated in a beautiful country setting. Set well back from the street for complete privacy, the Edwardian style residence has 3 bedrooms, formal dining, bathroom and living area that would suit any family, other features include wood heating, open fire place, wall air conditioner, large 8 x 18 (approx.) shed/workshop. Inspect today to insure you dont miss out on this prime 10 Acre location.

Land Size : 40468.6 sqm

View : <https://www.ypa.com.au/7399155>



Vickie Ramon
0403 194 621

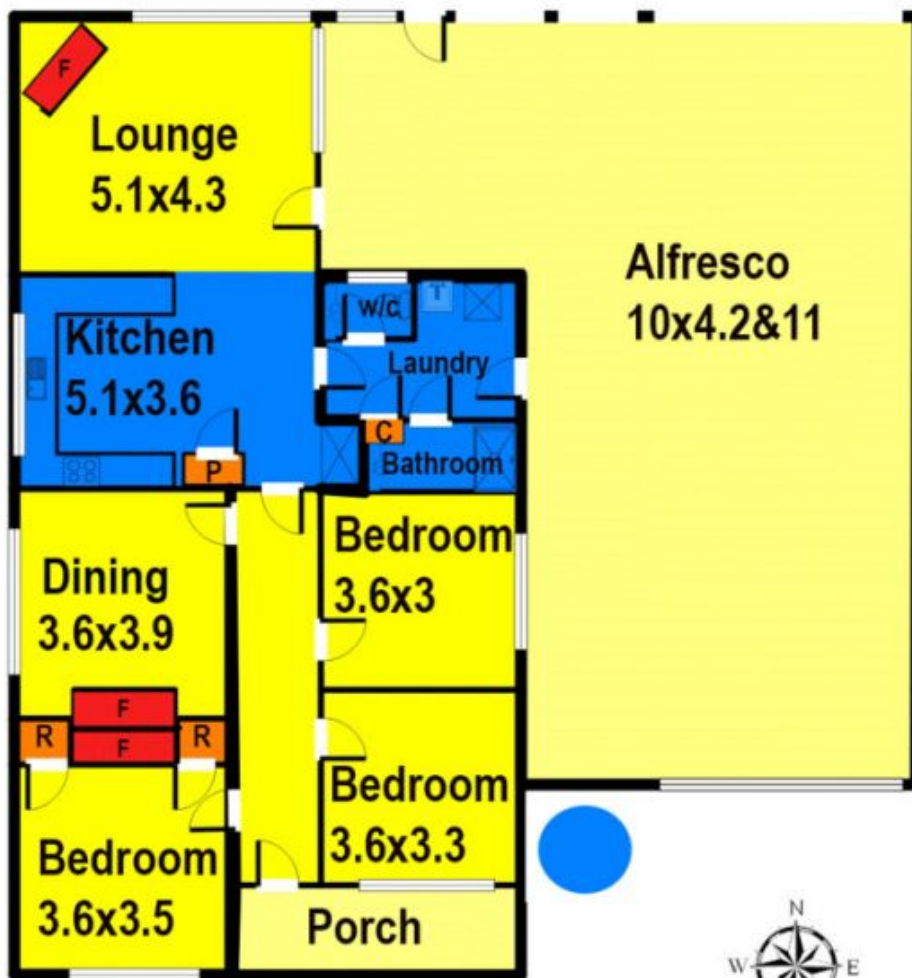

865 Exford Road Exford

Floor plan measurements are approximate and are for illustrative purposes only. While we do not doubt the floor plan's accuracy we make no guarantee, warranty or representation as to the accuracy and completeness of the floor plan. You or your advisors should conduct a careful investigation of the property to determine your satisfaction as to the suitability for your space requirements.