



43 Citronelle Circuit BROOKFIELD VIC

4  2  2 

Situated in one of Meltons finest estates Botanical Springs, this spacious family home meets every modern priority with ease, elegance and efficiency. Comprising of four generous size bedrooms, (master with full ensuite and WIR), designer kitchen that opens out to light filled dining area and large open living space with a separate rumpus room. Boasting: central bright bathroom ducted heating & evaporative cooling allows comfortable living all year round. Quality fixtures throughout just adds to the finishing touches. Car accommodation is matched with a double remote garage including internal access and entertaining is covered with an under roof line alfresco complemented by a large back yard perfect for the kids. This wonderful family home awaits one lucky party.

Land Size : 634 sqm

View : <https://www.ypa.com.au/7399162>



Shane Spiteri
0488 980 115

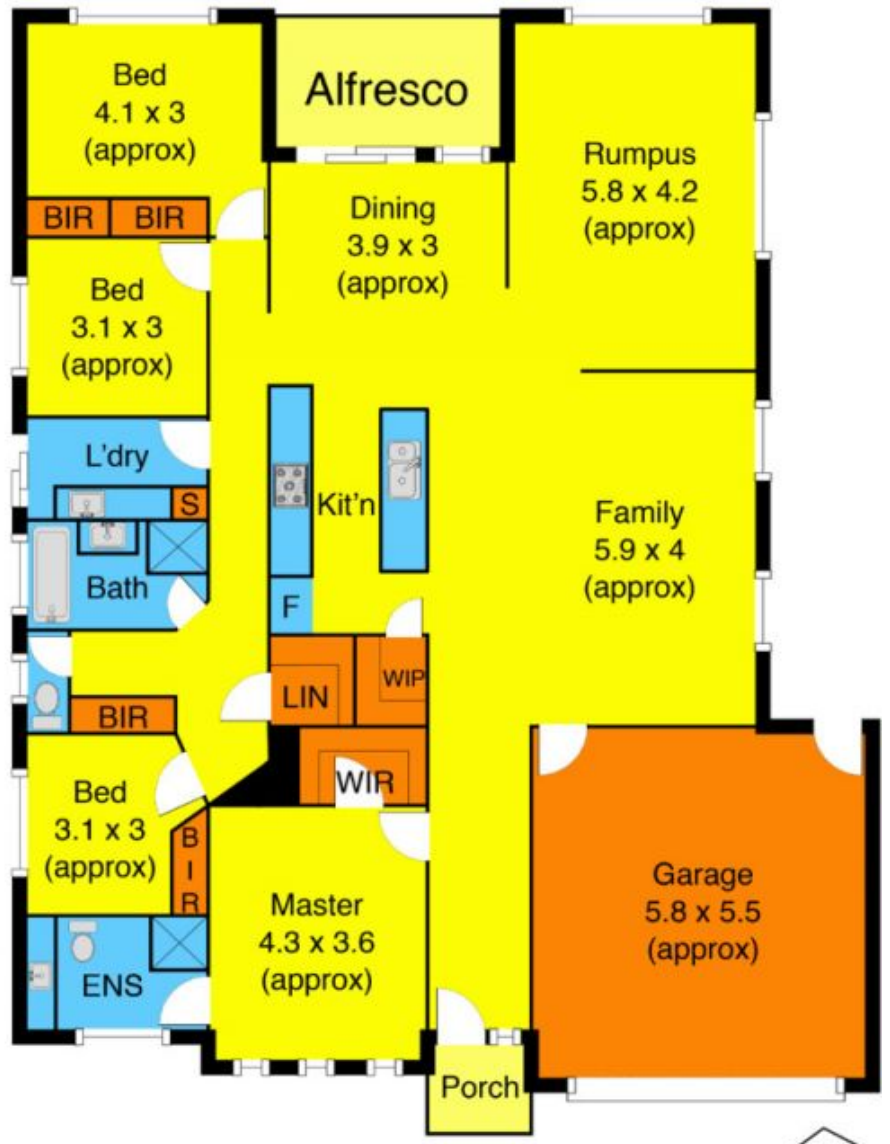

Citronelle Circuit

