



43 Vista Drive MELTON VIC

4 1

This beautifully refurbished home features an inviting lounge upon entry, four large bedrooms with built in robes, spacious central bathroom and well-appointed open plan modern kitchen and spacious dining, featuring: stainless steel appliances, ample storage and bench space, overlooking a beautifully landscaped front garden, further complimented by very large backyard to entertain whilst the kids run and play.

Land Size : 587 sqm

View : <https://www.ypa.com.au/7399190>

Set on a generous 587m2 block (approx.), located in highly sought after central location close to local schools, shops, parklands and public transport, this wonderfully maintained and well-presented home has all the WOW factors you could wish for.

Currently receiving a rental return of \$300 per week, secured until October 2017.

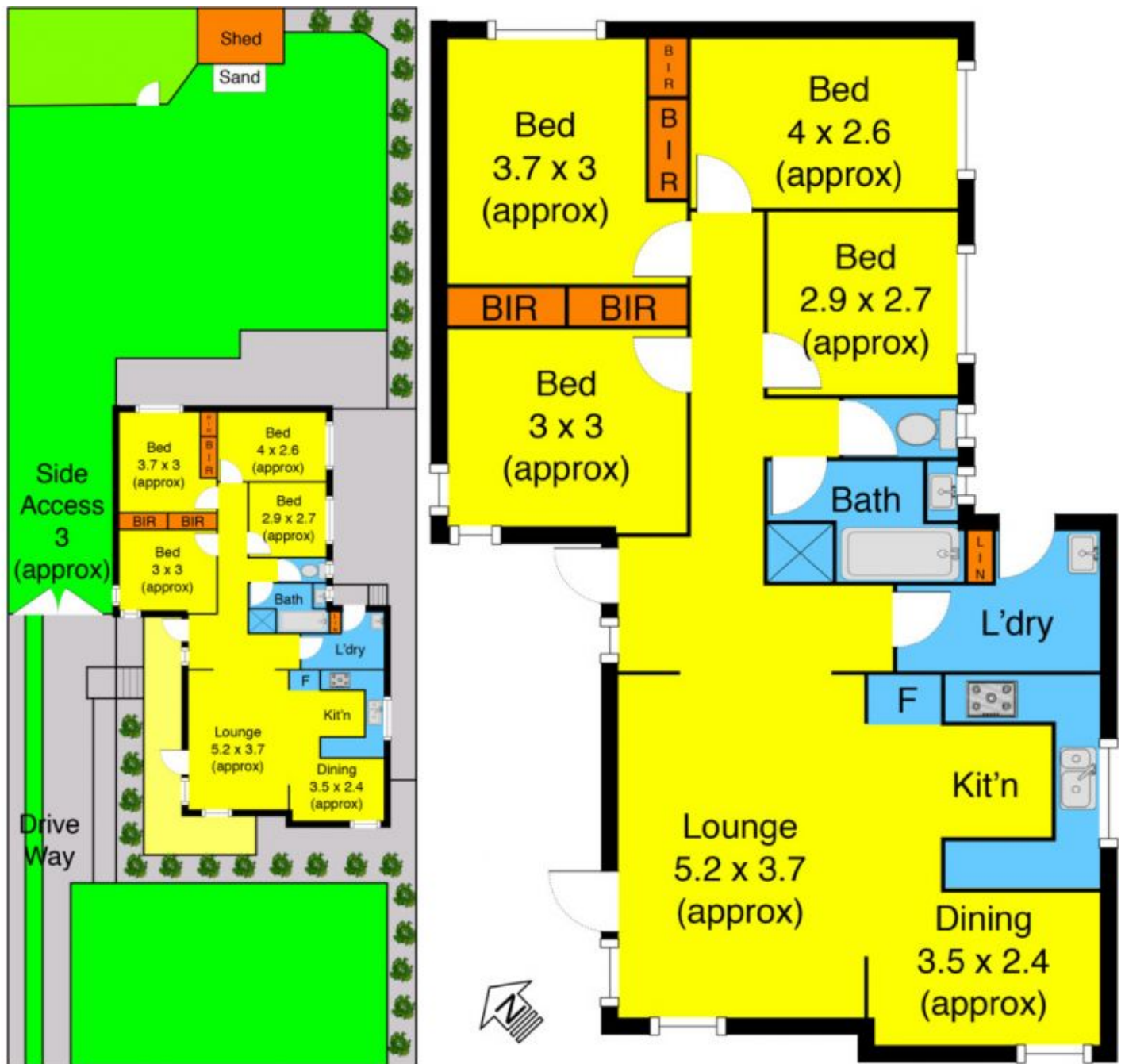

Vista Dr