



## 10 Galilee Boulevard MELTON WEST VIC

4  2  2 

Displaying an impressive blend of captivating modern features and impeccable character, the generous proportions of this home make for a sensational family domain located in the Navan Park estate in Melton West. This home offers glamorous ambience throughout in combination with the finest and latest upgrades makes this a fantastic value for your money. Comprising of four bedrooms, master bedroom with walk in robe & full ensuite. The beautiful kitchen not only appeals aesthetically but boasts a long list of upgrades including high quality appliances, Tasmanian Oak cabinetry, 80mm stone benchtops, under mount double sink and ample storage. The light-filled free flowing floor plan, with large front formal lounge with adjoining formal dining, as well as open plan dining and rumpus room creates living for the whole family. Complimented further by high vaulted ceilings, bay windows & natural gas fire place feature, this home

**Land Size** : 730 sqm  
**View** : <https://www.ypa.com.au/7399227>



**Mark Edwards**  
0422 017 068

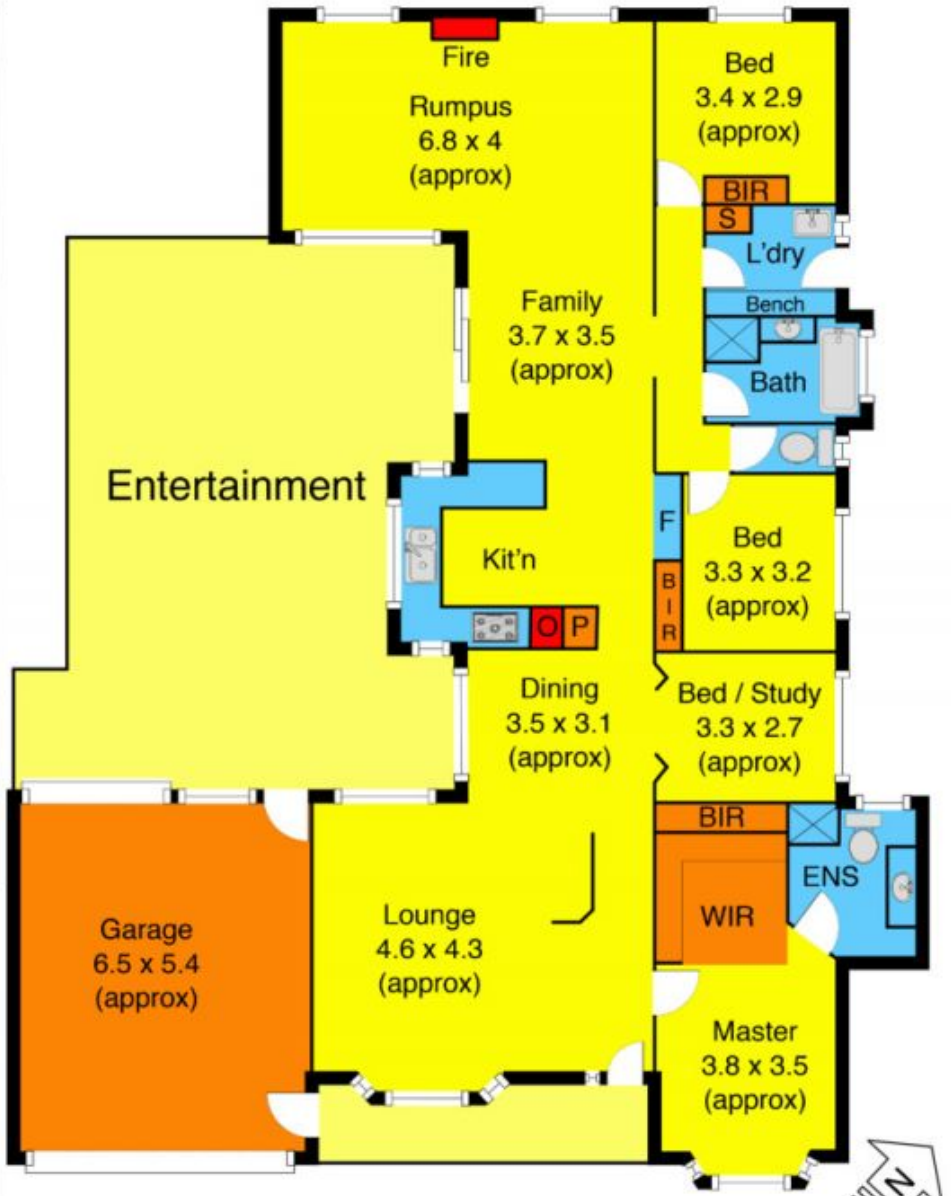

Galilee Blvd

