



246 Clarkes Road BROOKFIELD VIC

5 3 10

This is truly an opportunity to not only secure a pristine family home in one of the most sought after locations in Brookfield, but also one of the best residential blocks in town. Set on an impressive 1839m² (approx.) block of prime Brookfield land, this outstanding & awe inspiring residence including features that dreams comprise of, upon entering the property, the oversized feature entrance way will have you impressed from the first step in the door, offering five great sized bedrooms, master bedroom with full ensuite, walk in robe and secondary built in robes for all your clothing & storage needs, huge central bathroom, large formal lounge area, beautifully displayed kitchen area, complemented by stainless steel appliances & enormous pantry space. Complementing the free flowing floor plan is your living area placed alongside your meals/dining area and rumpus room. Outside, your unimaginably large shed/workshop is large enough to

Land Size : 1839 sqm

View : <https://www.ypa.com.au/7399229>

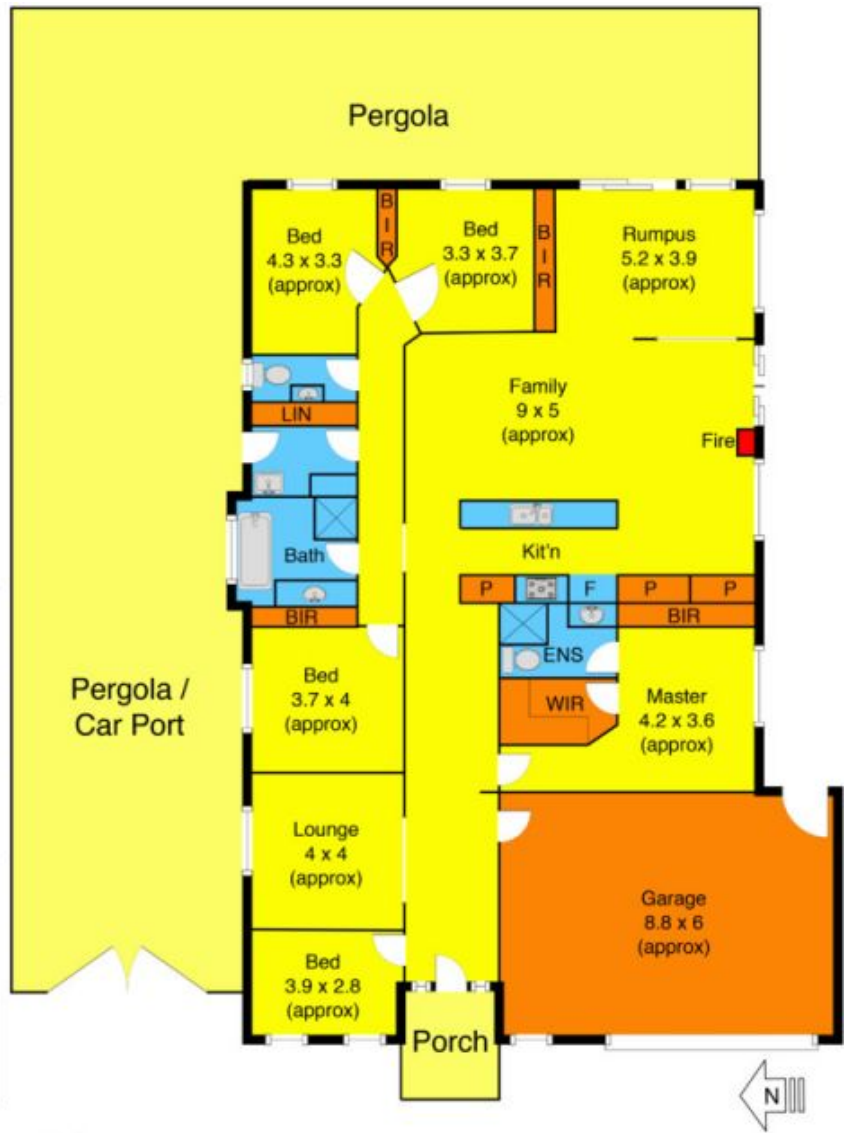
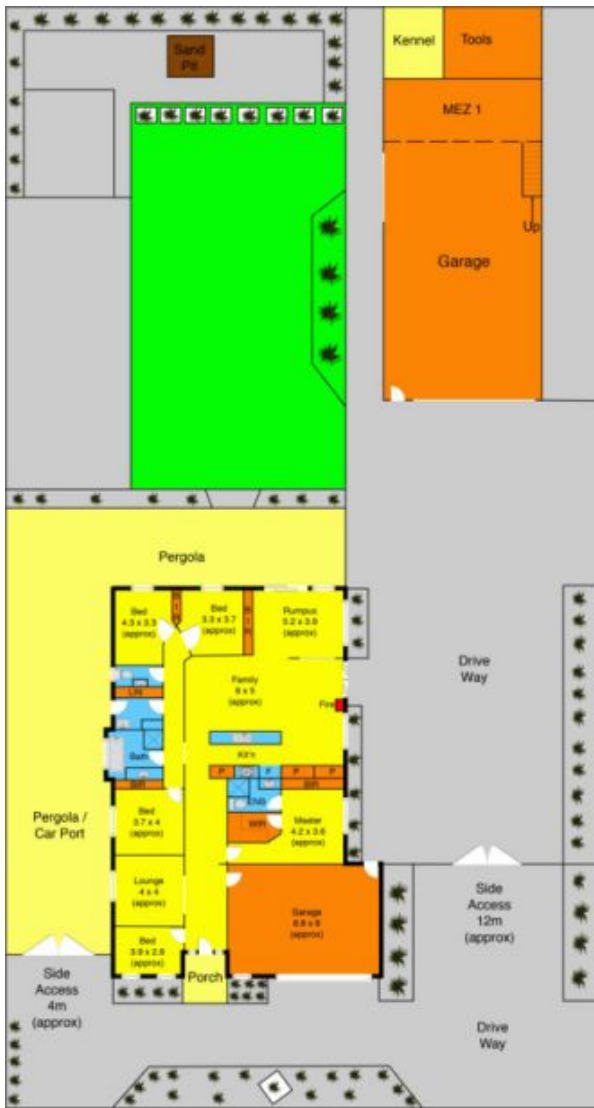

Clarke's Rd