



11 Wentworth Road MELTON SOUTH VIC

3 1 1

Irrespective of whether you are an investor looking for that perfect portfolio addition or a buyer looking for a property to call home, this exciting piece of real estate is the one for you, perfectly positioned on a massive 580m² (Approx) corner block, this home has so much character and endless potential. Located within walking distance from Melton train station, medical centres, public transport, brand new shopping district and all levels of schooling, you would be hard pushed to find a more appealing investment location. Comprising of three bedrooms, large lounge room, meals area, kitchen, central bathroom, this exclusive home is complemented by a wonderful corner block location with feature courtyard and pond to provide you with all the tranquillity you need. Truly a rare opportunity to purchase a property with the potential to build your investment portfolio. Call Shane O'Brien today to find out more and organise your inspection.

Land Size : 580 sqm

View : <https://www.ypa.com.au/7399247>

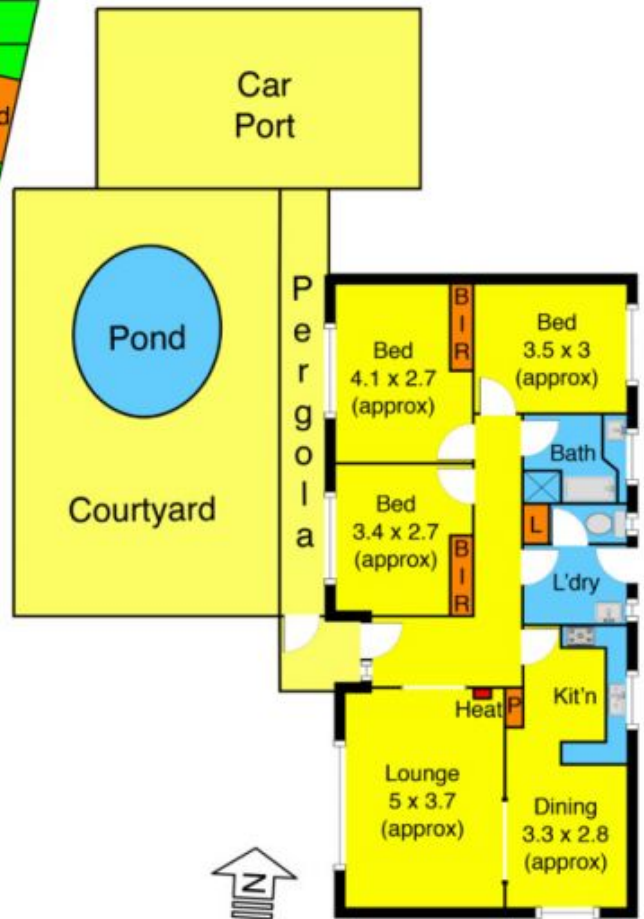

Wentworth Rd