



35/20-22 Roslyn Park Drive MELTON WEST VIC

3  **2**  **1** 

Perfect entry into the property market or great asset to any investment portfolio!

This sleek design and stunning property is boasting 3 generously sized bedrooms with BIR, (master with ensuite and WIR), bright spacious lounge with open meals area, kitchen with stainless steel appliances and ample storage space with a modern central bathroom adding complete comfort.

Sliding doors open out to stunning green garden and backyard while drive through assess adds everything you need for extra convenience!

Special features include: ducted heating, cooling, fully landscaped gardens, water tank and lock-up car garage.

Completed to the highest standards - this property is not going to last long in this booming market!! Don't wait, call today to organise your inspection.

View : <https://www.ypa.com.au/7399264>



Shane Spiteri
0488 980 115

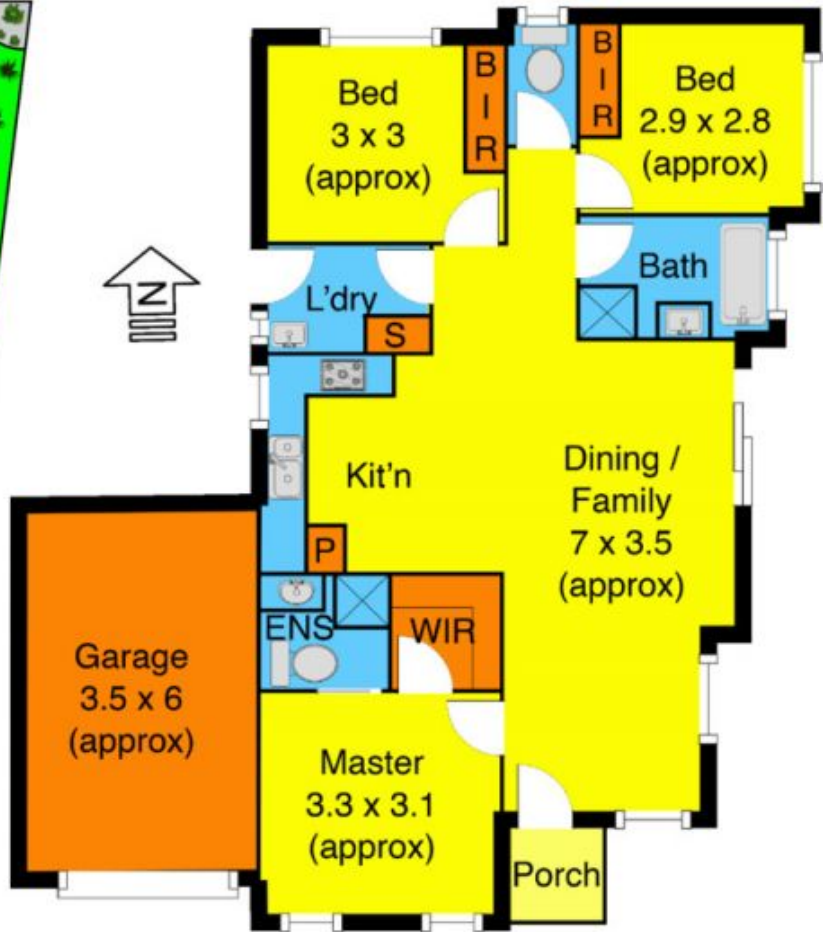

Roslyn Park Tce