



22 Nimmo Crescent KURUNJANG VIC

4  2  2 

Upon entering this well-maintained family home, you will instantly feel the comfort and space on offer. With no more to do, this great home is ready for you to move straight in.

Comprising of four fantastic sized bedrooms all complete with built in robes, master bedroom further complimented with walk-in-robe and a large ensuite, the heart of the home provides ample living space for any growing family featuring 2 separate living zones and a bonus study area, a well-appointed kitchen and adjoining meals area with ample cupboard and storage space.

Moving outside, this huge 645m² allotment is the perfect size for the kids to run and play and enjoy the outdoors, while you entertain under your pergola all-year-around!

Other special features include: fireplace, heating,

Land Size : 645 sqm
View : <https://www.ypa.com.au/7399273>



Shane Spiteri
0488 980 115

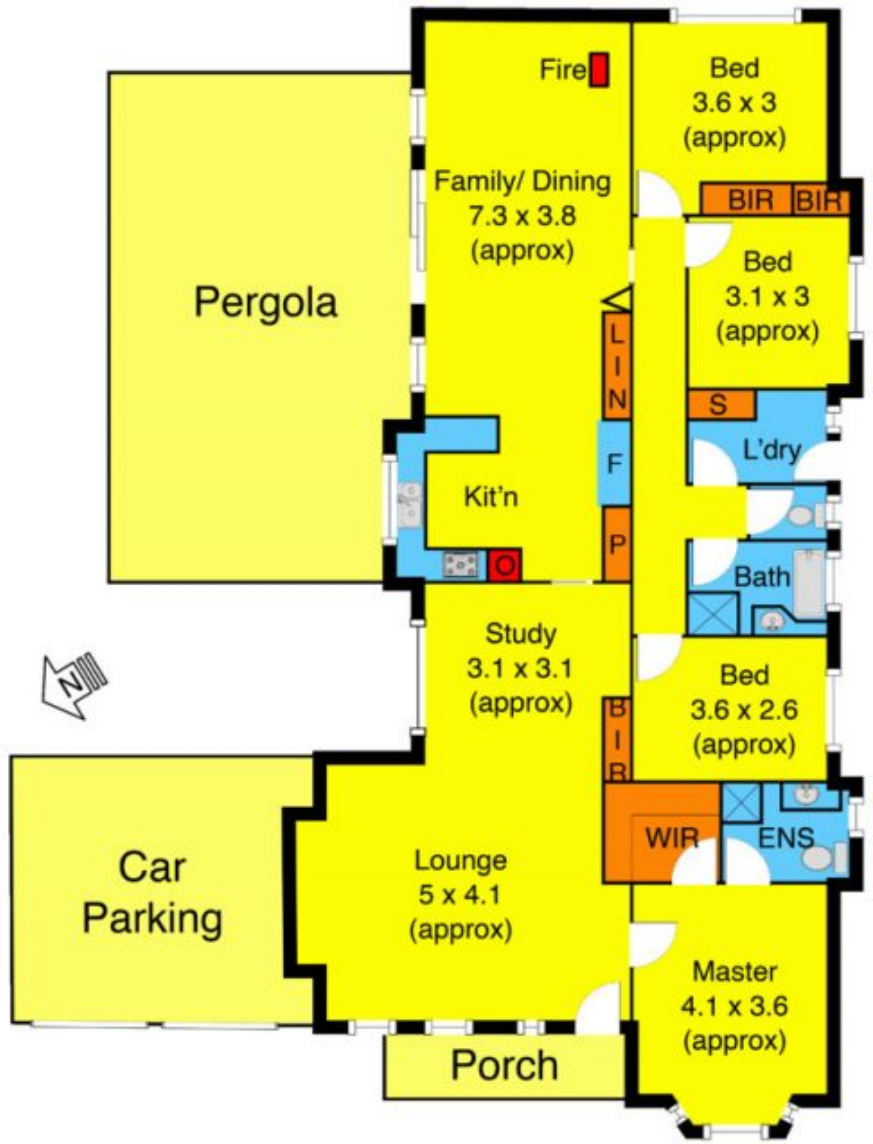
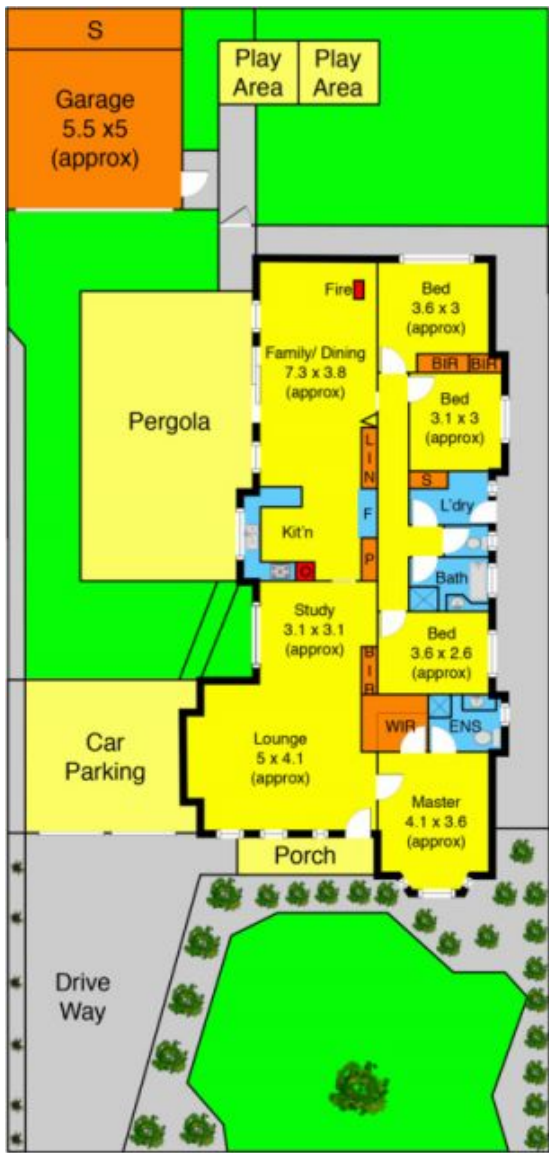

Nimmo Cres