



637 Eynesbury Road EYNESBURY VIC

4 🏠 2 🚗 2 🚗

Gracefully positioned in a sought after township of Eynesbury, this immaculately presented home merges character and stylish contemporary class for an outstanding family to move straight in and enjoy the space and freedom. The home comprises of 4 spacious bedrooms with the master containing a full en-suite and walk-in robe with remaining bedrooms all having built-in robes.

Let the family run free with formal lounge upon entry, open plan living/meals area, hostess gallery kitchen with stone benchtops, quality appliances and ample amounts of natural light overlooking oversized alfresco and landscaped surrounds. Extra features include double car garage, ducted heating and cooling 9ft ceilings and low maintenance gardens. Inspections are defiantly going to impress, contact your listing agent today to inspect.

Land Size : 539 sqm

View : <https://www.ypa.com.au/7399280>



Mark Edwards
0422 017 068

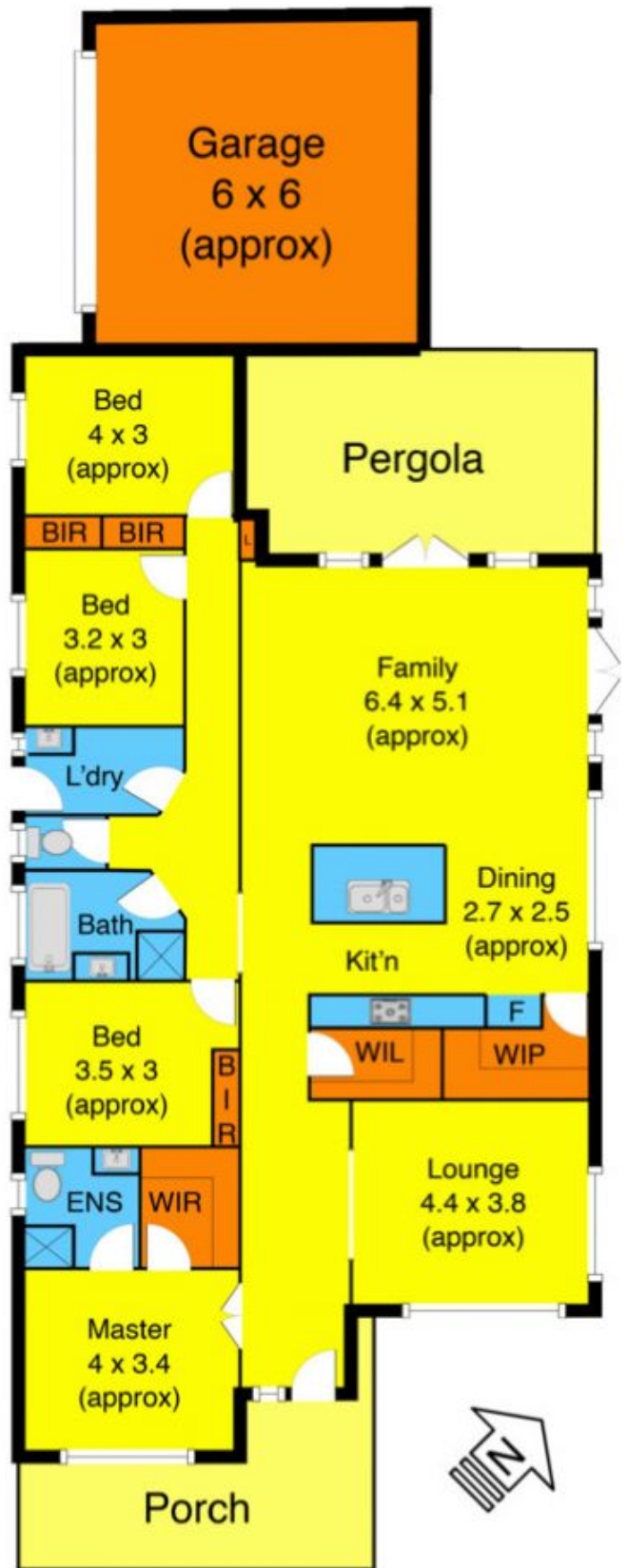
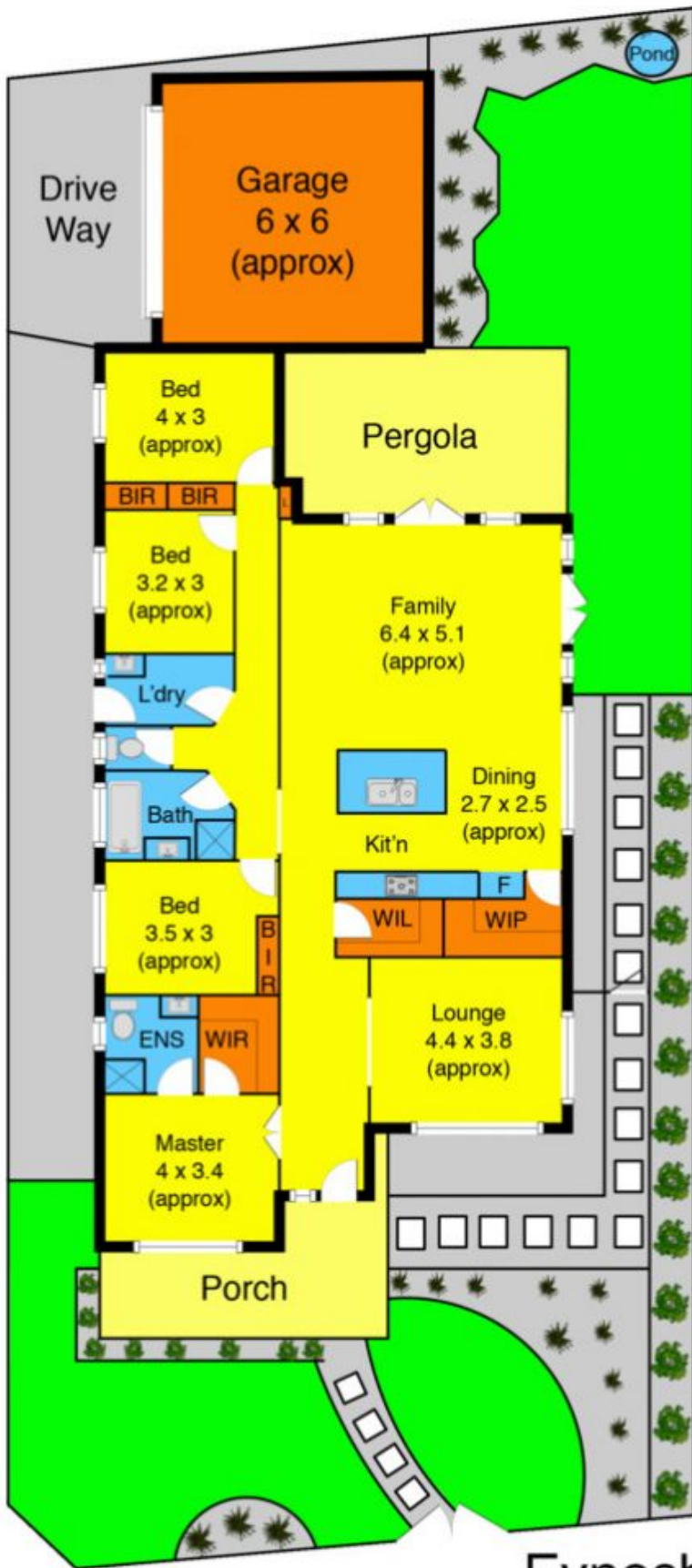

Eynesbury Rd